



2/9 Kawana Street, Alstonville

Quality and location on the Plateau

This simply stunning open plan home with space, privacy and position, will be a delight to inspect. Located in one of the best pockets of the Alstonville village in a quiet cul-de-sac from the moment you walk inside, this classic home showcases endless features and quality.

Features

- Spacious 3 bedrooms with built-ins & fans
- Master bedroom with en-suite
- Generous open plan lounge and dining with neutral colour tones throughout
- Beautifully designed kitchen, with pantry & dishwasher
- Covered alfresco entertaining area with complete privacy and northerly aspect
- Double remote garage with internal access
- Generous main bathroom
- Laundry with ample storage

Additional features include - Terracotta Tiles. ... Security screens and doors ... Plantation shutters ... Solar panels (6.6kw) ... Solar hot water .

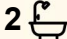
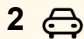
3  2  2 

FOR SALE

\$960,000 - \$1,000,000

AGENTS

Vicki Heathwood

0432 247 264

vheathwood.alstonville@ljhooker.com.au

AGENCY

LJ Hooker Alstonville

(02) 6628 1163

All information contained therein is gathered from relevant third parties sources. We cannot guarantee or give any warranty about the information provided. Interested parties must rely solely on their own enquiries.

 **LJ Hooker**

A timeless, quality home with class and inspections are invited with Exclusive Agent Vicki Heathwood.

MORE DETAILS

Property ID	16QRF55
Property Type	House
Land Area	500 m2
Including	Ensuite
	Air Conditioning
	Dishwasher
	Outdoor Entertaining
	Built-in-Robes
	Fully Fenced
	Remote Garage
	Solar Hot Water

Vicki Heathwood 0432 247 264

Sales Consultant/Licensed Real Estate Agent |
vheathwood.alstonville@ljhooker.com.au

LJ Hooker Alstonville (02) 6628 1163

Shop 16 The Plaza, ALSTONVILLE NSW 2477
alstonville.ljhooker.com.au | alstonville@ljhooker.com.au



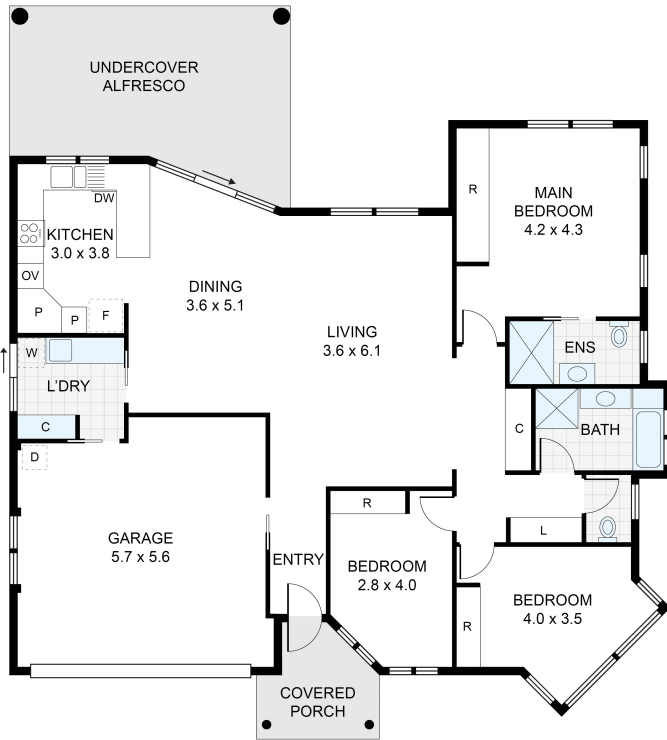

RESIDENCE : 165m²

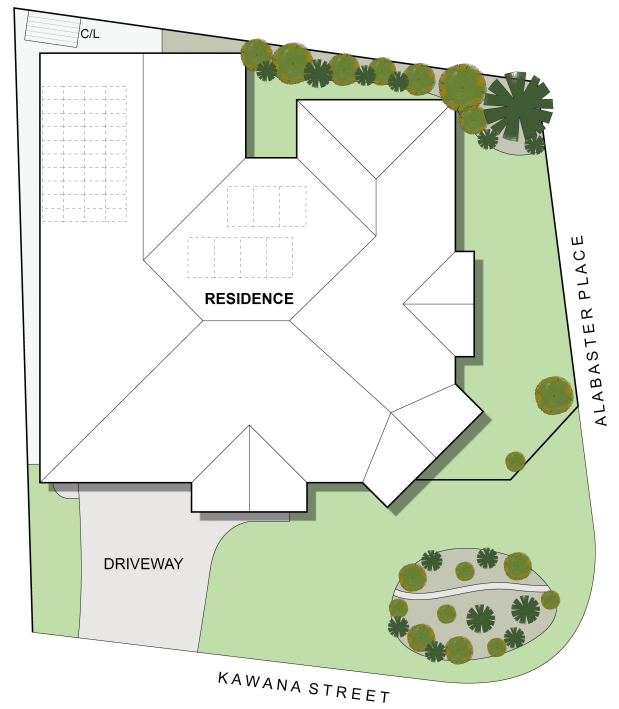

SITE PLAN

2/9 Kawana Street, Alstonville

Floor Plan Disclaimer: Media Drive (MD) floor plans / site plans are intended as an approximate guide only. No representations or warranties of any nature are given or intended and any person using this information other than as a guide should always rely on their own enquiries. Media Drive property marketing services: (41)97954 / Photography, Floor plans, Video, Aerial photography / www.mediadrive.com.au



APPROXIMATE AREAS
INTERNAL FLOOR SPACE - 133m ²
EXTERNAL FLOOR SPACE - 31m ²
GARAGE - 32m ²

All information contained therein is gathered from relevant third parties sources. We cannot guarantee or give any warranty about the information provided. Interested parties must rely solely on their own enquiries.