



12 Solara Court, Alstonville

Immaculate Home in Quality Location

This solid built, modern family home is located in the much sought after, prestigious 'Panorama Estate'. The family friendly floorplan consists of 3 good sized bedrooms plus a study, formal lounge and dining room, large family room off the galley style kitchen, internal laundry and 2 bathrooms. (Main bathroom with separate toilet acts as an ensuite to the master bedroom). There is a double remote garage plus plenty of storage within the home.

Flowing out from the family room is an extra-large undercover outdoor entertainment area with low-maintenance decking and shutters offering a lovely north-east aspect, a perfect spot for family gatherings or to enjoy your morning cuppa.

The property also offers a good sized fully fenced backyard for those who really need space for the kids and pets ... or simply love to potter in the garden and grow some fruit trees.

Extra features include : Energy efficient Solar panels plus solar hot water system, air-conditioning to family room, ceiling fans throughout, bedrooms have built-in wardrobes, main bathroom has been beautifully renovated and acts as an ensuite to the main bedroom,

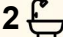
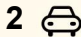
3  2  2 

FOR SALE

Please Call

AGENTS

Michele Wallace
0413 686 913
mwallace.alstonville@ljhooker.com.au

AGENCY

LJ Hooker Alstonville
(02) 6628 1163

All information contained therein is gathered from relevant third parties sources.
We cannot guarantee or give any warranty about the information provided.
Interested parties must rely solely on their own enquiries.



modern plantation shutters to all windows.

This lovely property will impress on first inspection!
Call exclusive agent Michele Wallace to find out more...

MORE DETAILS

Property ID	14JKF55
Property Type	House
Land Area	737 m2
Including	Study
	Air Conditioning
	Toilets (2)
	Deck
	Dishwasher
	Outdoor Entertaining
	Workshop
	Built-in-Robes
	Secure Parking
	Fully Fenced
	Remote Garage
	Solar Panels
	Solar Hot Water

Michele Wallace 0413 686 913

Sales Consultant/Licensed Real Estate Agent |
mwallace.alstonville@ljhooker.com.au

LJ Hooker Alstonville (02) 6628 1163

Shop 16 The Plaza, ALSTONVILLE NSW 2477
alstonville.ljhooker.com.au | alstonville@ljhooker.com.au



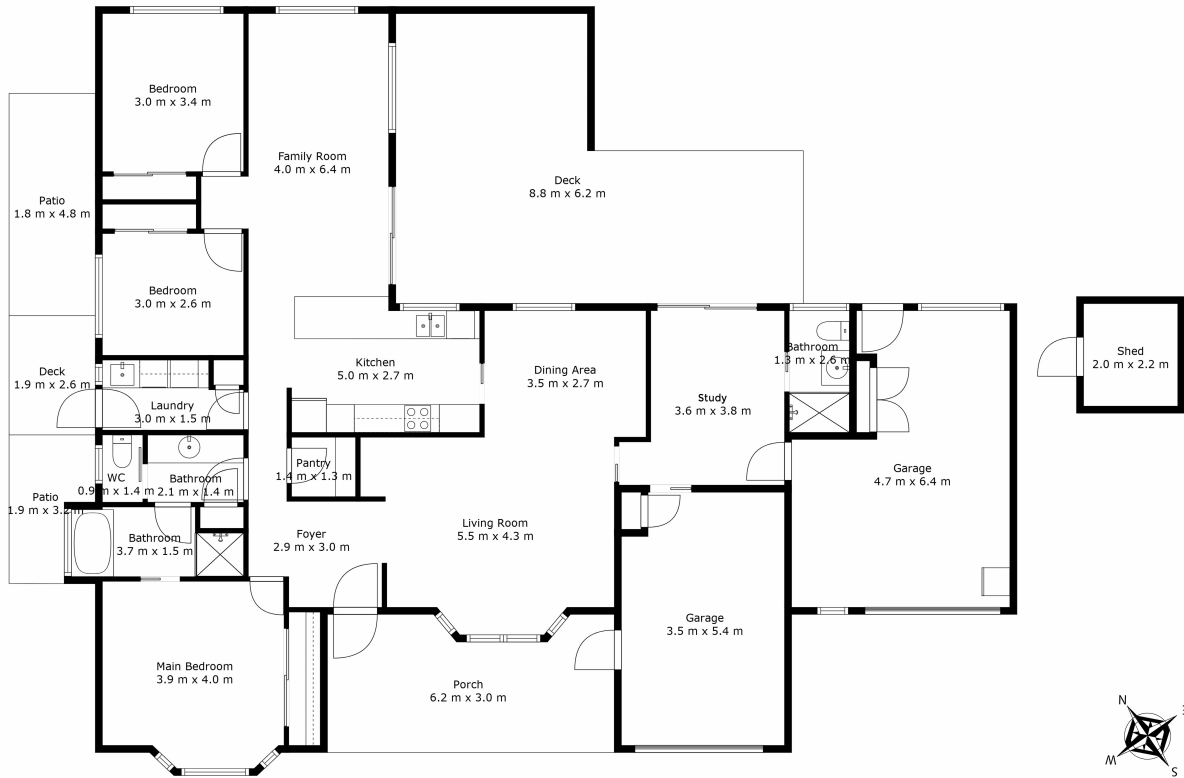

12 SOLARA COURT, ALSTONVILLE

Disclaimer: For illustrative purpose only Floor plan measurements, size, and scale are approximate we take no responsibility for omission and errors.



All information contained therein is gathered from relevant third parties sources.
 We cannot guarantee or give any warranty about the information provided.
 Interested parties must rely solely on their own enquiries.

