

Allambie Heights, 21 Allambie Road

Sleek contemporary entertainer with sweeping views

From its innovative contemporary design and panoramic 180-degree views to its fabulous alfresco entertaining areas and near-level rear lawn, this modern residence provides a luxuriously livable lifestyle haven for families. Set back from the street and accessed via a private driveway, it is located opposite Gumbooya Reserve and only 180 metres to the bus stop to Manly, Chatswood and the city express and within close proximity schools, Warringah Mall and a selection of beaches.

- District views extend from the ocean and St Patrick's at Manly to the city skyline
- Gaze over the district to leafy bushland ridges and twinkling nightlights
- Enormous living space and the huge separate dining area soak in the views
- Glass sliding doors open to an entertainer's deck with relaxing views
- Sleek marble-look stone island kitchen, gas cooktop, wall and steam ovens
- Butler's pantry has a stone bench, a sink and a stainless steel dishwasher
- Oversized bedrooms with mirrored built-in wardrobes and ceiling fans

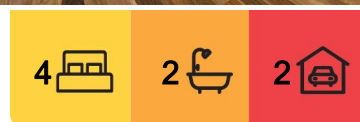

Auction

Sat 31st May @ 10:00AM

View

Sat 10th May @ 10:00AM - 10:30AM

Contact

Tim Wirth

0421 997 845

tim@ljhseaforth.com.au

Glen Wirth

0411 249 955

gwirth@ljhseaforth.com.au



LJ Hooker Seaforth
(02) 9948 7080

Disclaimer: All information contained therein is gathered from relevant third parties sources. We cannot guarantee or give any warranty about the information provided. Interested parties must rely solely on their own enquiries.

- Main with walk-in robe, ensuite and district views opens to the rear deck
- Ultra-chic bathrooms, main with a standalone bath and twin wash basins
- Soaring raked ceilings, timber flooring, air con and surround sound
- Enormous lower terrace with a covered entertaining area and leafy vistas
- The basement area has been fashioned into a rumpus retreat/storage
- Fully enclosed near level lawn area plus a sunny north lawn and garden
- Automatic double lock-up garage extends to the basement retreat area
- Allambie Heights Primary School and the new Forest High are just up the street
- 1.4km to Allambie Heights Village and 4.4km Northern Beaches Hospital

More About this Property

Property ID	185EF78
Property Type	House
House Size	238 m2
Land Area	768 m2

Tim Wirth 0421 997 845
Principal | tim@ljhseaforth.com.au
Glen Wirth 0411 249 955
Principal | gwirth@ljhseaforth.com.au

LJ Hooker Seaforth (02) 9948 7080
553 Sydney Road, SEAFORTH NSW 2092
seaforth.ljhooker.com.au | seaforth@ljhseaforth.com.au



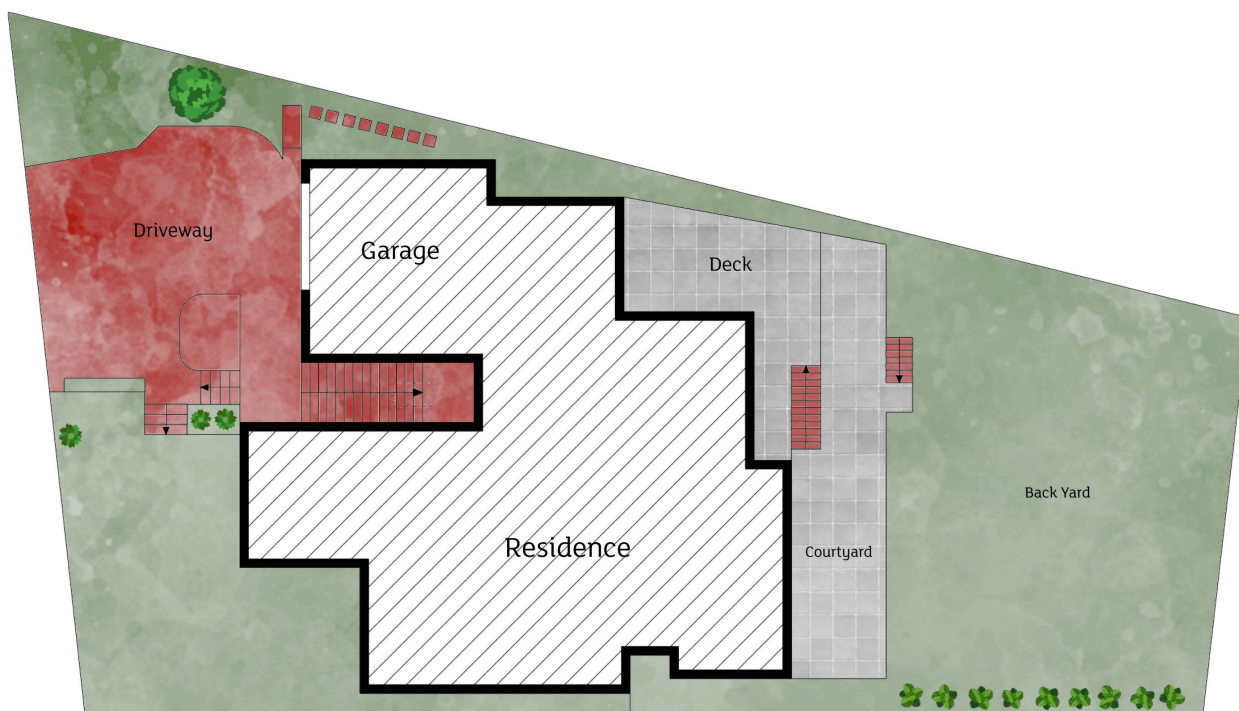

Site Plan

21 Allambie Road, Allambie Heights

The site plan is not to scale. Bushes and trees are placed for illustration purposes.
Plans should not be relied on. Interested parties should make and rely on their own enquiries.

 **LJ Hooker**
Seaforth

Produced by DIAKRIT