



31 Wigham Road, Aldinga Beach

## Charming 1970's Home on a Generous Allotment

Welcome to 31 Wigham Road, Aldinga Beach —a classic 1970s residence set on a spacious allotment of approximately 850m<sup>2</sup>, offering endless potential for homeowners, renovators or investors alike.

This solidly built home captures the character of its era, with a practical layout and plenty of room to make it your own. Whether you're looking to move straight in, update over time, or explore future development possibilities (STCC), this property provides a fantastic foundation.

A standout feature is the secure undercover parking, including a double garage and workshop space —ideal for tradies, hobbyists, or those needing extra storage.

Outdoor living is well catered for with a pitched all-weather pergola, perfect for entertaining year-round with family and friends.

The expansive block offers ample space for additional outdoor living, gardening, or future enhancements. Located in the sought-after coastal suburb of Aldinga Beach, you'll enjoy a relaxed lifestyle just moments from local shops, schools, and the stunning shoreline.

Don't miss this opportunity to secure a sizable property in a growing coastal community. Enquire today to arrange your inspection.

3 1 4

**FOR SALE**

Please Call

**AGENTS**

John McGarry

0438 563 588

[jmcgarry.aldinga@ljhooker.com.au](mailto:jmcgarry.aldinga@ljhooker.com.au)

**AGENCY**

LJ Hooker Aldinga | Seaford

(08) 8556 5249

All information contained therein is gathered from relevant third parties sources.  
We cannot guarantee or give any warranty about the information provided.  
Interested parties must rely solely on their own enquiries.

LJ Hooker

## MORE DETAILS

Property ID 7SJ24  
Property Type House  
Land Area 850 m2  
Including Toilets (1)

**John McGarry 0438 563 588**

Principal | Licencee | [jmcgarry.aldinga@ljhooker.com.au](mailto:jmcgarry.aldinga@ljhooker.com.au)

**LJ Hooker Aldinga | Seaford (08) 8556 5249**

80 Aldinga Beach Road, ALDINGA BEACH SA 5173  
[aldinga.ljhooker.com.au](http://aldinga.ljhooker.com.au) | [accounts.aldinga@ljhooker.com.au](mailto:accounts.aldinga@ljhooker.com.au)



All information contained therein is gathered from relevant third parties sources.  
We cannot guarantee or give any warranty about the information provided.  
Interested parties must rely solely on their own enquiries.

31 Wigham Road,  
ALDINGA BEACH

Living: 115.70sqm  
Carport: 24.00sqm  
Garage: 45.00sqm  
Workshop/Verandah: 79.60sqm  
Total: 264.30sqm

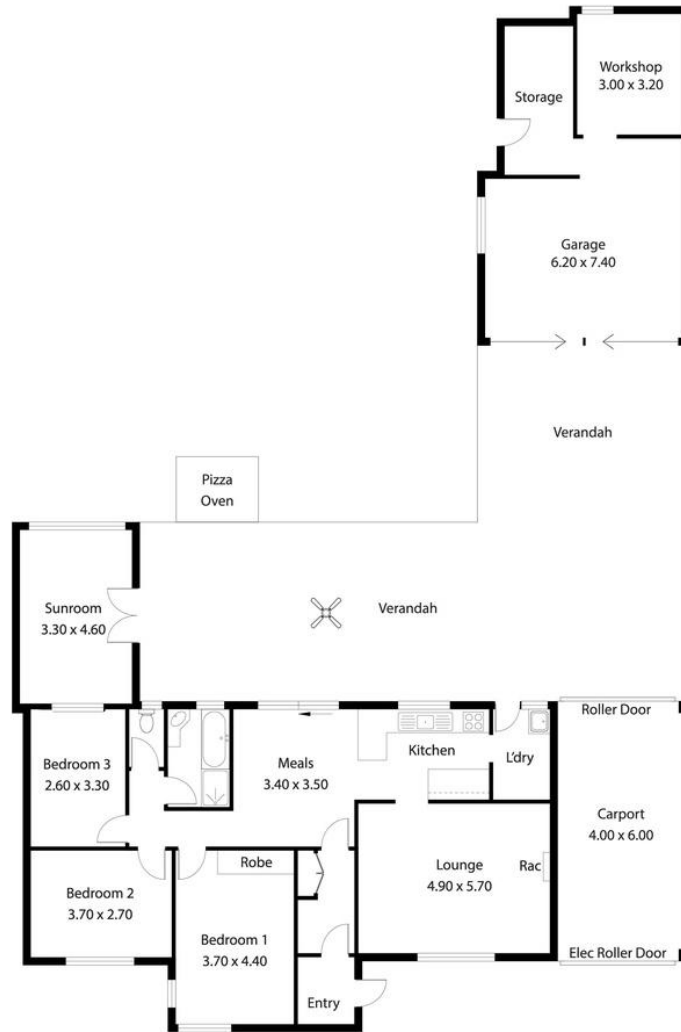

This Drawing is for illustration purposes only.  
Not To Scale. All measurements are internal and approximate.  
Details intended to be relied upon should be independently verified.

Produced by [Open2view.com](http://Open2view.com)