



8 Treefern Close, Aberglasslyn

IMMACULATE BRICK & TILE FAMILY HOME!!

Perfectly positioned in a quiet cul-de-sac surrounded by other quality homes, 8 Treefern Close, Aberglasslyn presents an opportunity to secure an impeccably maintained family residence that's move-in ready yet offers scope for personal touches.

This brick and tile home, lovingly cared for by its owners for 27 years, sits proudly on a generous 664sqm parcel and delivers a wonderful sense of space, comfort, and functionality. Inside, multiple living zones cater to the modern family lifestyle - from the elegant formal lounge and dining area at the front to the informal meals and rumpus spaces at the rear, all enjoying year-round comfort via reverse cycle ducted air conditioning and ceiling fans.

The well-appointed laminate kitchen provides plenty of bench and cupboard space and comes complete with modern appliances - ideal for busy households or those who love to entertain. Four spacious bedrooms, all with built-in robes and ceiling fans, are conveniently located near the family bathroom, while the master bedroom includes a private ensuite and walk-in robe.

Step outside to a delightful enclosed entertaining area, perfect for

4  2  2 

FOR SALE
\$845,000

AGENTS

Kane Bradley
0423 525 335
kbradley.maitland@ljhooker.com.au

AGENCY

LJ Hooker Maitland
(02) 4933 5511

All information contained therein is gathered from relevant third parties sources.
We cannot guarantee or give any warranty about the information provided.
Interested parties must rely solely on their own enquiries.

 **LJ Hooker**

family gatherings or morning coffee, overlooking a beautifully maintained backyard brimming with established trees, shrubs, and a productive veggie garden. The double garage with drive-through access and multiple garden sheds add practicality and storage.

This is a home that has clearly been cherished and maintained to the highest standard. Whether you're a young family, downsizer, or investor, 8 Treefern Close offers the perfect blend of space, comfort, and opportunity in one of Aberglasslyn's most desirable pockets.

Don't miss this chance to secure a true gem - ready to move in and make your own.

Proudly marketed by LJ Hooker Maitland, please call exclusive agent Kane Bradley 0423 525 335 7 days for all inspections & further information.

All information contained herein is gathered from sources we deem to be reliable. However, we cannot guarantee its accuracy and interested persons should rely on their own enquiries.

MORE DETAILS

| | |
|---------------|--------------------|
| Property ID | 1EK8F6H |
| Property Type | House |
| Land Area | 664 m2 |
| Including | Ensuite |
| | Air Conditioning |
| | Toilets (2) |
| | Built-in-Robes |
| | Close to Schools |
| | Close to Transport |
| | Liveability |

Kane Bradley 0423 525 335
Director | kbradley.maitland@ljhooker.com.au

LJ Hooker Maitland (02) 4933 5511
24 Ken Tubman Drive, MAITLAND NSW 2320
maitland.ljhooker.com.au | maitland@ljhooker.com.au



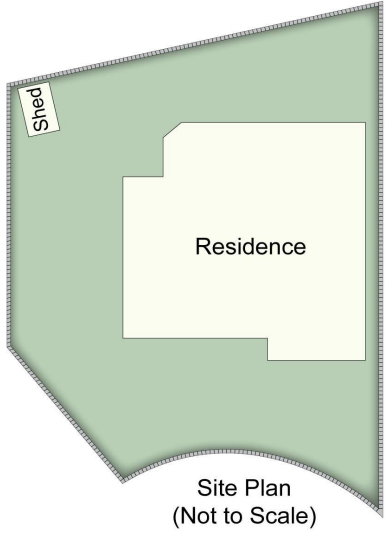
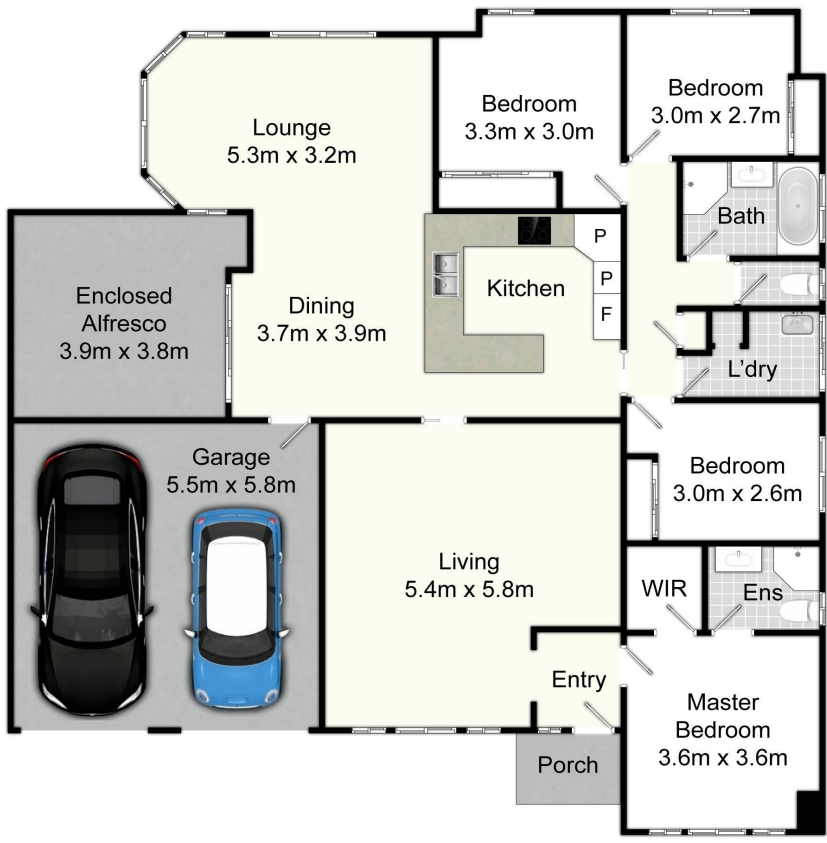

8 Treefern Cl, Aberglasslyn

All information contained herein is gathered from sources we deem reliable. However, we cannot guarantee its accuracy and act as a messenger only in passing on the details. Interested parties should rely on their own inquiries and the contract for sale. The floor plans are artist's impressions only. The site plan is not to scale.



All information contained therein is gathered from relevant third parties sources. We cannot guarantee or give any warranty about the information provided. Interested parties must rely solely on their own enquiries.

