



Timaru, 3/10 Matilda Street

Handy to Town

This two bedroom unit is available for long term renting. Open plan living and bathroom downstairs and two double bedrooms upstairs.

You have your own private courtyard where you can enjoy a barbecue or just relax in the fresh outside air. Off-street parking for two vehicles. Sorry no pets.

To book a viewing or to apply for this property, please copy the following link into your browser: <https://apply.tenant.co.nz/594943>

2

1

0

For Lease
Please Call

View
ljhooker.co.nz/12F5GTA

Contact
Lesley Groundwater
027 222 5473
lesley.timaru@ljhooker.co.nz



Disclaimer: All information contained therein is gathered from relevant third parties sources. We cannot guarantee or give any warranty about the information provided. Interested parties must rely solely on their own enquiries.

LJ Hooker Timaru
(03) 688 3029
Enting Real Estate Limited

More About this Property

| | |
|--|---------|
| Property ID | 12F5GTA |
| Property Type | Unit |
| Licensed Real Estate Agents (REAA2008) | |

Lesley Groundwater 027 222 5473

Consultant - Property Management | lesley.timaru@ljhooker.co.nz

LJ Hooker Timaru (03) 688 3029

Enting Real Estate Limited

51 Church Street, TIMARU 7910

timaru.ljhooker.co.nz | timaru@ljhooker.co.nz

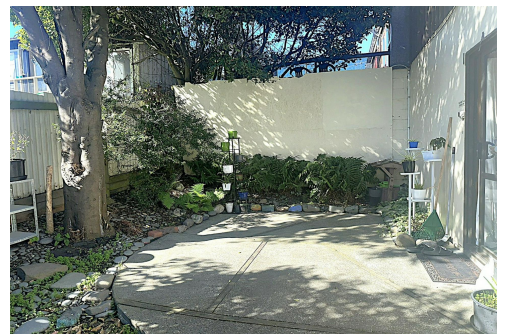

Disclaimer: All information contained therein is gathered from relevant third parties sources.

We cannot guarantee or give any warranty about the information provided. Interested parties must rely solely on their own enquiries.

LJ Hooker Timaru

(03) 688 3029

Enting Real Estate Limited