

Tahmoor, 25 Janice Drive

Near New Home with Solar Power

Ready for the ideal next tenant. Equipped with all the modern requirements, stunning new kitchen and bathrooms and excellent living areas. Solar power unit that will dramatically reduce your power costs.

Features include:

- Near new kitchen with large stone bench top.
- Tiled living areas and carpeted bedrooms.
- Main bedroom with walk in and ensuite.
- Single garage with remote door.
- Rainwater tank.
- Air conditioning.
- Fans in all bedrooms.
- Plumbed fridge space.

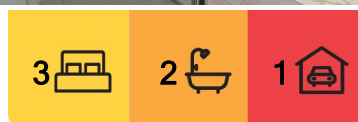

For Lease
Please Call

View
ljhooker.com.au/41ZHV8

Contact
April Sutton
pm.picton@ljhooker.com.au



Disclaimer: All information contained therein is gathered from relevant third parties sources. We cannot guarantee or give any warranty about the information provided. Interested parties must rely solely on their own enquiries.

LJ Hooker Picton
(02) 4677 3441

--This property has a granny flat attached, which is not included in this lease--

Please note: Applications will only be processed if the property has been viewed in person.
QR code to submit application will be provided at time of inspection.

More About this Property

Property ID 41ZHV8

Property Type House

April Sutton

Property Investment Manager | pm.picton@ljhooker.com.au

LJ Hooker Picton (02) 4677 3441

Suite 20, 150-158 Argyle Street, PICTON NSW 2571

picton.ljhooker.com.au | picton@ljhooker.com.au

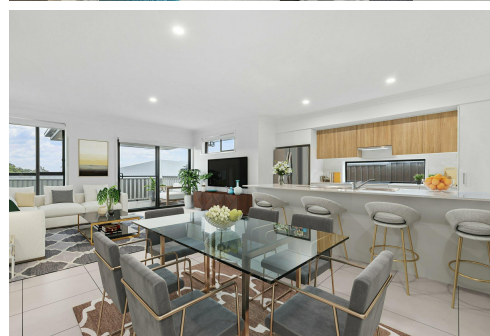

25 Janice Street Tahmoor

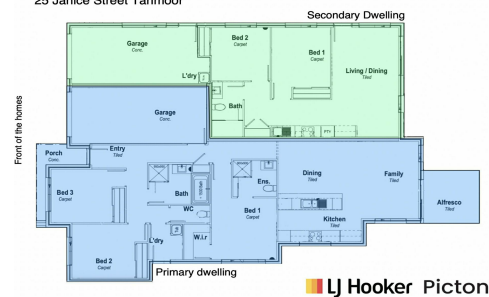

LJ Hooker Picton
(02) 4677 3441

Disclaimer: All information contained therein is gathered from relevant third parties sources.
We cannot guarantee or give any warranty about the information provided. Interested parties must rely solely on their own enquiries.