

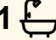



Leased



11 Mayo Crescent, Salisbury Downs

3  1  1 

Family Home in Salisbury Downs with Pool

OPEN INSPECTION TIME: Click REQUEST INSPECTION button on website listing

Rent: \$640.00 Per week

Bond: \$2,560.00

Available Date: 01/12/2025

6/12 Month Lease

Pets Negotiable

Smoking outside only

FOR RENT

Please Call

AGENTS

Wendy Page

wendy.page@ljhces.com.au

AGENCY

LJ Hooker Craigmore | Elizabeth |

Salisbury

(08) 8255 9555

Apply online at: www.2apply.com

You are welcome to complete an application form online prior to viewing.

Once you have signed up for an inspection time on the website listing, we will contact you via text message with a viewing time.

Do not call for a viewing time; one will be allocated to you once you have signed up via the website.

There will be no exceptions to this process.

All information contained therein is gathered from relevant third parties sources. We cannot guarantee or give any warranty about the information provided. Interested parties must rely solely on their own enquiries.

 **LJ Hooker**

Features:

- Formal lounge at the front of the home with warm wooden floorboards and a wall heater, perfect for cozy evenings.
- Functional flow from the lounge to the open kitchen and meals area, ideal for family living or entertaining.
- The kitchen boasts ample overhead cabinetry for storage, gas cooktop for efficient cooking, plenty of bench space and cupboards for convenience and breakfast bar, perfect for casual dining or entertaining.
- Three good-sized bedrooms, all featuring built-in robes for ample storage.
- The main bathroom has floor-to-ceiling tiles for a sleek look, built-in spa bath for relaxation and Combined toilet for added functionality.
- Second toilet located adjacent to the main bathroom for extra convenience.
- Wooden floorboards throughout the entrance, front lounge, and bedrooms, adding warmth and charm.
- Ducted evaporative cooling throughout the home and wall mounted heater in the lounge for year-round comfort.
- In-ground pool, perfect for summer relaxation or entertaining.
- Concreted verandah area overlooking the pool, providing an ideal space for outdoor gatherings.
- Additional spacious semi-enclosed verandah with gate access to the front of the home.
- Generous shedding, both open and enclosed spaces for storing vehicles, tools, or setting up a workshop and side access with two roller doors, allowing easy access to the shed, verandah, and carport.

LJ Hooker Craigmores | Elizabeth | Salisbury: the number one Real Estate Agents / Sale Agents and Property Management in the Northern Suburbs of South Australia.

Specialists in: Andrews Farm, Angle Vale, Blakeview, Burton, Craigmores, Davoren Park, Elizabeth and surrounding, Gawler, Hillbank, Munno Para, One Tree Hill, Parafield, Para Hills, Paralowie, Salisbury, Smithfield.

Disclaimer:

We have in preparing this document used our best endeavours to ensure the information contained is true and accurate, but accept no responsibility and disclaim all liability in respect to any errors, omissions, inaccuracies or misstatements contained. Prospective tenants should make their own enquiries to verify the information contained in this document.

RLA155355

MORE DETAILS

Property ID 67ZZFDC
Property Type House

Wendy Page

Property Investment Department Manager |
wendy.page@ljhcs.com.au

LJ Hooker Craigmores | Elizabeth | Salisbury (08) 8255 9555

Shop 17, Craigmores Village, Yorktown Road, CRAIGMORE SA 5114
craigmoreselizabeth.ljhooker.com.au | Office@ljhcs.com.au



11 Myer Crescent,
SALISBURY DOWNS

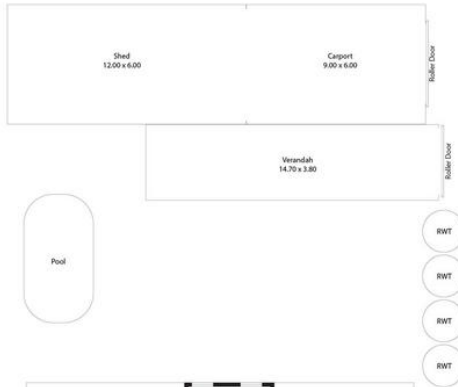

Living: 113.990QM
Verandah: 116.202QM
TOTAL: 229.200QM

This Drawing is for illustration purposes only. All measurements are internal and approximate. Details intended to be noted upon should be independently verified.