



Pearcedale, 940 North Road

PEACEFUL LIFESTYLE!!!

Enjoy the peaceful lifestyle this large family home offers, with a perfect blend of country, comfort and convenience.

The home includes:

- Master bedroom with large robes and a private ensuite.
- Remaining bedrooms with built in robes.
- A generously sized timber kitchen, including dual wall-mounted ovens and dishwasher with countryside views.
- Sunroom for additional space.
- Hardwood timber flooring throughout, carpet to living and bedrooms.

*STABLES AND PADDOCKS NOT INCLUDED FOR TENANCY



Disclaimer: All information contained therein is gathered from relevant third parties sources. We cannot guarantee or give any warranty about the information provided. Interested parties must rely solely on their own enquiries.

LEASED

4

2

0

For Lease

Please Call

View

ljhooker.com.au/47VJPFHE

Contact

Brooke Foster

brooke.foster@ljhcasey.com.au

LJ Hooker Hampton Park
(03) 9702 8388

Minutes away from Botanic Ridge shopping precinct and a short to drive to Cranbourne. Lifestyle is the award here, come and see for yourself.

RENT PER CALENDAR MONTH = \$2,520.00
BOND = \$2,520.00

More About this Property

Property ID	47VJPFHE
Property Type	House
Including	Ensuite Built-in-Robes Carpeted Close to Shops

Brooke Foster
Property Manager | brooke.foster@ljhcasey.com.au

LJ Hooker Hampton Park (03) 9702 8388
Shop 20, Hampton Park Shopping Centre, 166 Somerville Road, HAMPTON PARK VIC 3976
hamptonpark.ljhooker.com.au | john.deo@ljhcasey.com.au

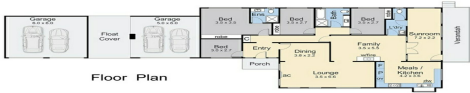

LJ Hooker Hampton Park
(03) 9702 8388

Disclaimer: All information contained therein is gathered from relevant third parties sources. We cannot guarantee or give any warranty about the information provided. Interested parties must rely solely on their own enquiries.