



## New Lambton, 1 Young Road

Spacious home in a handy location!

This charming 3-bedroom cottage offers comfort and convenience, ideally located right across the road from McDonald Jones Stadium. Features include:

- 3 spacious bedrooms with plenty of natural light
- Functional original bathroom with bathtub
- Well appointed kitchen complete with a walk-in pantry
- Large lounge room perfect for relaxing
- Separate dining area ideal for family meals
- Enclosed yard offering privacy and space

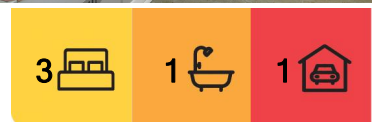

**For Lease**  
Please Call

**View**  
[ljhooker.com.au/16MPF5E](http://ljhooker.com.au/16MPF5E)

**Contact**  
**Rachel Ellis**  
[office@ljhookerbelmont.com.au](mailto:office@ljhookerbelmont.com.au)  
**Melanie Hodge**  
0484 844 477  
[melanie@ljhookerbelmont.com.au](mailto:melanie@ljhookerbelmont.com.au)



**Disclaimer:** All information contained therein is gathered from relevant third parties sources. We cannot guarantee or give any warranty about the information provided. Interested parties must rely solely on their own enquiries.

**LJ Hooker Belmont**  
**(02) 4945 8600**

- Single lock-up garage

Don't miss the opportunity to live in this prime location, close to local amenities and public transport. Ideal for families or anyone looking to enjoy easy access to events at the stadium!

This information has been prepared to assist solely in the marketing of this property. While all care has been taken to ensure the information provided herein is correct, we do not take responsibility for any inaccuracies. Accordingly, all interested parties should make their own enquiries to verify the information.

## More About this Property

Property ID	16MPF5E
Property Type	House

### Rachel Ellis

Administration Assistant | [office@ljhookerbelmont.com.au](mailto:office@ljhookerbelmont.com.au)

### Melanie Hodge 0484 844 477

Team Leader of Property Management | [melanie@ljhookerbelmont.com.au](mailto:melanie@ljhookerbelmont.com.au)

### LJ Hooker Belmont (02) 4945 8600

562 Pacific Highway, BELMONT NSW 2280

[belmontnsw.ljhooker.com.au](http://belmontnsw.ljhooker.com.au) | [office@ljhookerbelmont.com.au](mailto:office@ljhookerbelmont.com.au)



**Disclaimer:** All information contained therein is gathered from relevant third parties sources. We cannot guarantee or give any warranty about the information provided. Interested parties must rely solely on their own enquiries.

**LJ Hooker Belmont**  
**(02) 4945 8600**



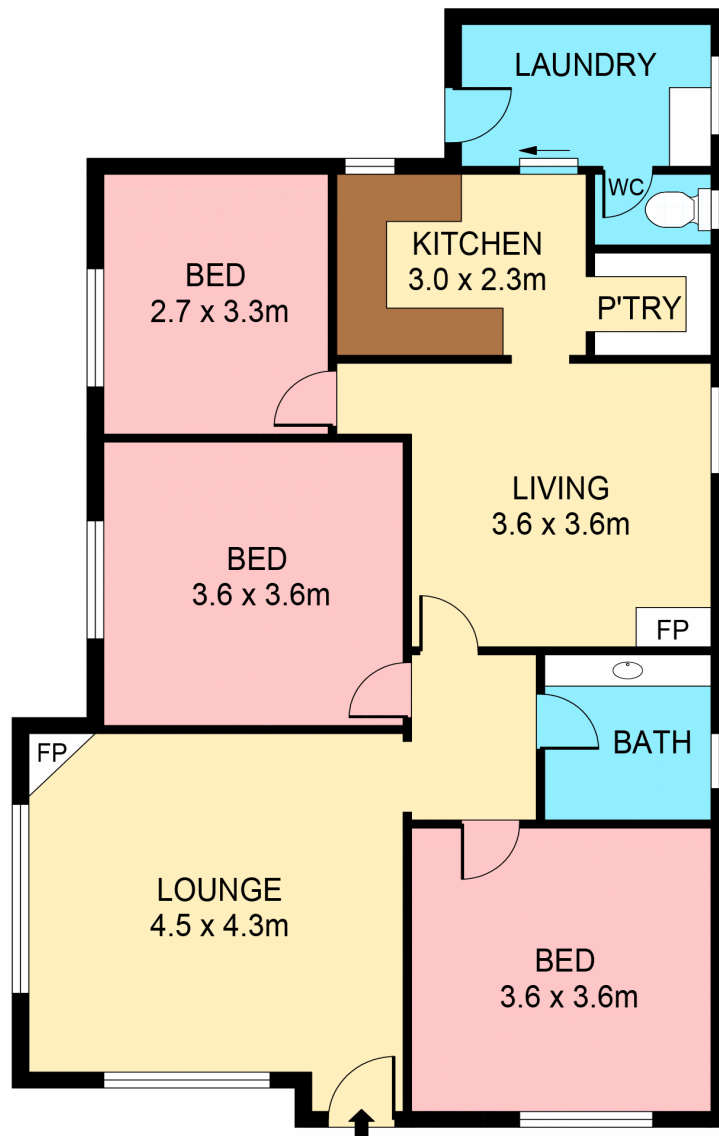
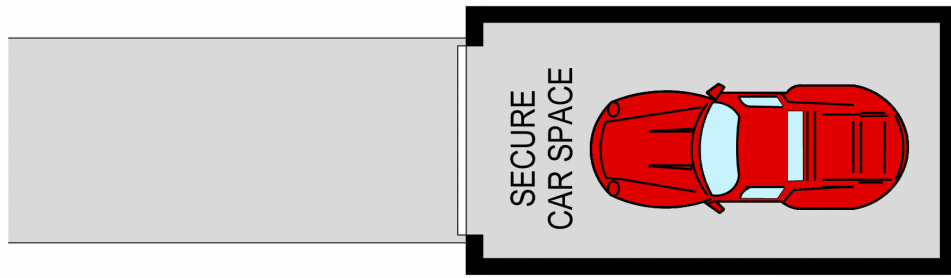

SCALE (METRES)

PLANS SHOWN ONLY INDICATIVE OF LAYOUT. DIMENSIONS ARE APPROXIMATE.

1 YOUNG ROAD

NEW LAMBTON



**LJ Hooker Belmont**  
(02) 4945 8600

**Disclaimer:** All information contained therein is gathered from relevant third parties sources.  
We cannot guarantee or give any warranty about the information provided. Interested parties must rely solely on their own enquiries.