



Lightsview, 205/62 City View Boulevard

Expansive City & Hill Views



This elevated and secure apartment is made for an easy care, lock up and leave lifestyle. Its thoughtful design and brilliant location is sure to impress. From here you're connected to the CBD and all the quality surrounding amenities including great cafes, shopping hubs, parks and public transport.

Features include:

- *Secure intercom access
- *High ceilings
- *Quality fixtures and fittings throughout
- *Open plan kitchen, living and dining
- *Living room opens to large balcony
- *Dining area includes a large dining table for your use
- *Kitchen with electric cooking, dishwasher, stone benchtops, ample cupboards and

For Lease

\$590 per week

View

By Appointment

Contact

Keith Brown

0402 353 240

keith.brown@ljhadelaidemetro.com.au



LJ Hooker St Peters
(08) 8362 8008

Disclaimer: All information contained therein is gathered from relevant third parties sources. We cannot guarantee or give any warranty about the information provided. Interested parties must rely solely on their own enquiries.

benchtop space

*Main bedroom with ceiling fan, a private balcony, built in robes and ensuite

*Second bedroom with built in robes

*Both bathrooms with shower, vanity and toilet

*European laundry

*2 x balconies making the most of the hills and city views

*Ducted reverse cycle air conditioning

*Gas hot water

*Single basement carpark and storage

*Facilities include an indoor heated pool, community bike rack and fully equipped gym

Experience the best of urban living with the Lightsview community at your doorstep. Enjoy leisurely strolls through the lush parks and scenic walking trails or indulge in the array of amenities including shopping centres, cafes, and recreational facilities. With easy access to the Adelaide CBD, commuting to work or exploring the city's vibrant culture and dining scene is a breeze. Don't miss this opportunity to elevate your lifestyle in Lightsview's urban oasis.

Water charges: Water usage and supply charges apply

Furniture: Unfurnished

Exclude: Lockable store room

NOTE ABOUT THE OPEN INSPECTIONS: Interested persons MUST register their details to attend any of the scheduled viewing dates and times allocated. The agent will not attend the listed viewing date and time if you do not register and confirm your attendance. It is for this reason we highly recommend you register to attend to ensure the agent's attendance and to avoid disappointment.

Disclaimer: All information provided has been obtained from sources we believe to be accurate, however, we cannot guarantee the information is accurate and we accept no liability for any errors or omissions. We encourage all interested parties to make their own enquiries, particularly regarding NBN/internet availability at the property.

More About this Property

Property ID	2CRSFDZ
Property Type	Apartment
Including	Ensuite Air Conditioning

Keith Brown 0402 353 240

Property Investment Manager | keith.brown@ljhadelaidemetro.com.au

LJ Hooker St Peters (08) 8362 8008

2a Portrush Road, PAYNEHAM SA 5070

stpeters.ljhooker.com.au | stpeters@ljhadelaidemetro.com.au



**LJ Hooker St Peters
(08) 8362 8008**

Disclaimer: All information contained therein is gathered from relevant third parties sources. We cannot guarantee or give any warranty about the information provided. Interested parties must rely solely on their own enquiries.

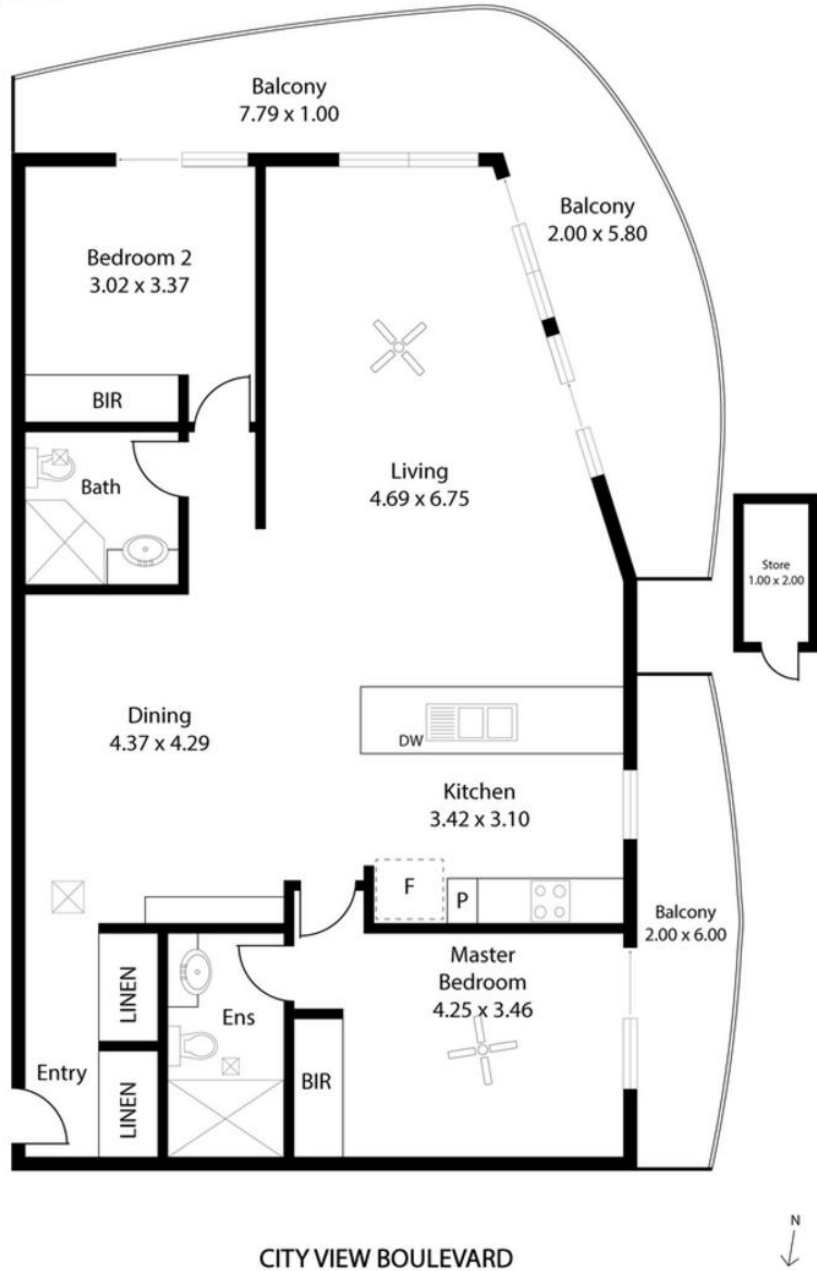

Living:	97.35 sqm
Store:	2.00 sqm
Balcony's:	29.55 sqm
Total:	128.90 sqm

This Drawing is for illustration purposes only.
All measurements are internal and approximate.
Details intended to be relied upon should be
independently verified
Produced by Open2view.com