

27 Casterley Road, Elizabeth North

Semi-detached Maisonette

OPEN INSPECTION TIME: Click REQUEST INSPECTION button on website listing

Rent: \$410.00 Per week

Bond: \$1,640.00

Available Date: 18th May 2026

12 Month Lease

Pets Negotiable

Smoking outside only

Owners Intent to Sell: No intent advised



Apply online at: www.2apply.com

You are welcome to complete an application form online prior to viewing.

Once you have signed up for an inspection time on the website listing, we will contact you via text message with a viewing time.

Do not call for a viewing time; one will be allocated to you once you have signed up via the website.

There will be no exceptions to this process.
Perfectly positioned close to the Munno Para Shopping complex,

3  1  1 

FOR RENT
\$410 per week

VIEW
Mon 15th Jun @ 4:00PM - 4:10PM

AGENTS
Wendy Page
wendy.page@ljhces.com.au

AGENCY
LJ Hooker Craigmore | Elizabeth |
Salisbury
(08) 8255 9555

All information contained therein is gathered from relevant third parties sources.
We cannot guarantee or give any warranty about the information provided.
Interested parties must rely solely on their own enquiries.

 **LJ Hooker**

Elizabeth North Primary School & Pre School as well as public transport.

This spacious allotment-ideal for families or tenants seeking room to grow.

Property Features:

- 3 well-sized bedrooms, all with timber flooring and neutral tones.
- Front lounge area offers split system for all round comfort
- Light-filled kitchen featuring: Tiled splash back, Ample cabinetry, Freestanding electric stove, Dishwasher and meals area
- Central bathroom with small style bath, ideal for the children
- Separate toilet for added convenience
- Fully fenced rear yard with double gate access

LJ Hooker Craigmores | Elizabeth | Salisbury: the number one Real Estate Agents / Sale Agents and Property Management in the Northern Suburbs of South Australia.

Specialists in: Andrews Farm, Angle Vale, Blakeview, Burton, Craigmores, Davoren Park, Elizabeth and surrounding, Gawler, Hillbank, Munno Para, One Tree Hill, Parafield, Para Hills, Paralowie, Salisbury, Smithfield.

Disclaimer:

We have in preparing this document used our best endeavours to ensure the information contained is true and accurate, but accept no responsibility and disclaim all liability in respect to any errors, omissions, inaccuracies or misstatements contained. Prospective tenants should make their own enquiries to verify the information contained in this document.

RLA155355

MORE DETAILS

Property ID 68STFDC
Property Type House

Wendy Page

Senior Investment Manager | wendy.page@ljhces.com.au

LJ Hooker Craigmores | Elizabeth | Salisbury (08) 8255 9555

Shop 17, Craigmores Village, Yorktown Road, CRAIGMORE SA 5114
craigmoreselizabeth.ljhooker.com.au | Office@ljhces.com.au



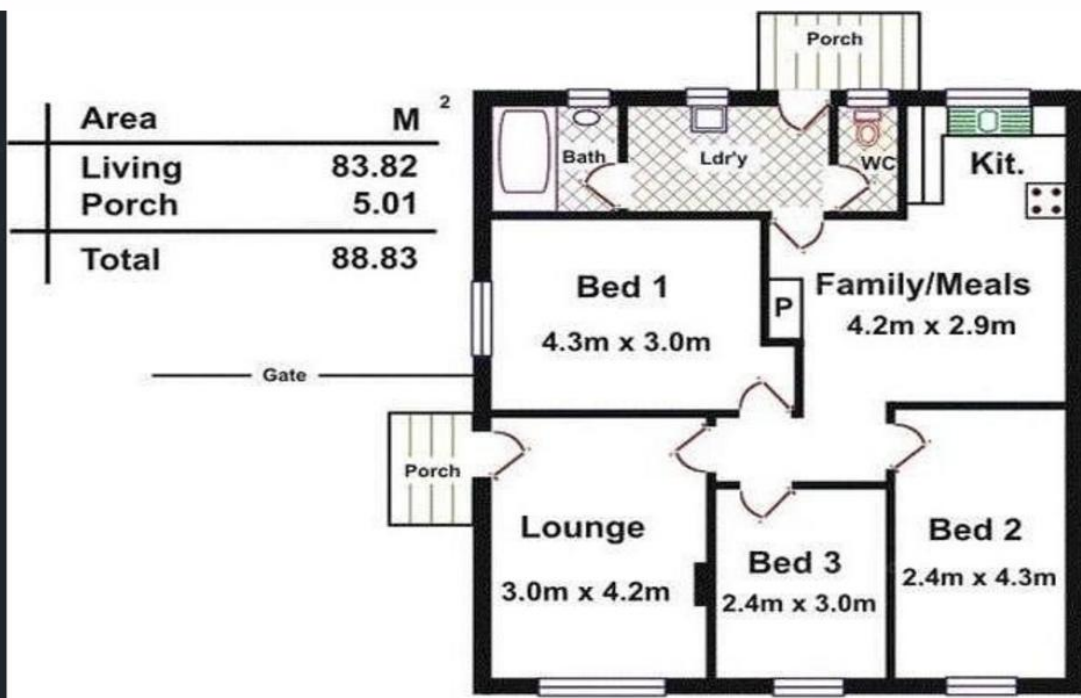

Area	M ²
Living Porch	83.82
Porch	5.01
Total	88.83

All information contained therein is gathered from relevant third parties sources.
 We cannot guarantee or give any warranty about the information provided.
 Interested parties must rely solely on their own enquiries.