



## Castle Hill, 11 Brunette Drive

**DEPOSIT TAKEN** Spacious 4 Bedroom Brick Home In Leafy Location

Set in popular Castle Hill East pocket within a leafy tree lined street, is this spacious four bedroom brick home. Featuring expansive open plan living rooms, with an additional oversized light fight sunroom opening out to a large pet friendly backyard.

Located to in the popular North Baulkham Hills Public School catchment area, Castle Hill Towers, the new railway station at Castle Hill and easily accessible to the busses to the city and the M2 motorway this property is ready for occupation now.

### Features

4 bedrooms with 3 bedrooms has built-in wardrobes

Spacious Living room with separate formal dining

Ample cupboard storage in the kitchen with and electric cooking and dishwasher

Oversized sun/rumpus room

5 split system air conditioning throughout



**Disclaimer:** All information contained therein is gathered from relevant third parties sources.

We cannot guarantee or give any warranty about the information provided. Interested parties must rely solely on their own enquiries.

4

2

2

**For Lease**  
Please Call

**View**  
[ljhooker.com.au/78JHHJ](http://ljhooker.com.au/78JHHJ)

**Contact**  
**Leanne Nehme**  
0414 977 907  
[leanne.nehme@ljhooker.com.au](mailto:leanne.nehme@ljhooker.com.au)

**LJ Hooker Bella Vista**  
**02 8608 2332**

Remote controlled double lock up garage with internal access  
Internal laundry with extra storage  
Pet Friendly backyard  
12 month lease  
\$800p/w

## More About this Property

Property ID	78JHHJ
Property Type	House
Including	Ensuite Toilets (2)

**Leanne Nehme 0414 977 907**  
Principal & Senior Sales Excecutive | [leanne.nehme@ljhooker.com.au](mailto:leanne.nehme@ljhooker.com.au)

**LJ Hooker Bella Vista 02 8608 2332**  
Shop 3, 1 Circa Boulevard, BELLA VISTA NSW 2153  
[bellavista.ljhooker.com.au](http://bellavista.ljhooker.com.au) | [bellavista@ljhooker.com.au](mailto:bellavista@ljhooker.com.au)



**LJ Hooker Bella Vista**  
**02 8608 2332**

**Disclaimer:** All information contained therein is gathered from relevant third parties sources.  
We cannot guarantee or give any warranty about the information provided. Interested parties must rely solely on their own enquiries.

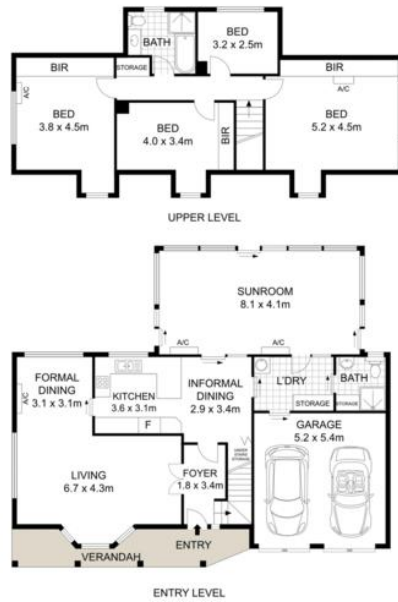

Internal area: 217 m<sup>2</sup>  
 External area: 12 m<sup>2</sup>  
 Garage area: 28 m<sup>2</sup>  
 Total area: 257 m<sup>2</sup>  
 Land area: 711 m<sup>2</sup>



## 11 Brunette Drive, Castle Hill

PLANS SHOWN ONLY INDICATIVE OF LAYOUT. DIMENSIONS ARE APPROXIMATE.  
 Measurements are approximate and not to scale. The vendor, agency and supplier will accept no liability for its accuracy. Interested parties are advised to make their own independent enquiries.