



## Beechmont, 74-78 Akoonah Drive

### UNIQUE LIGHT-FILLED HOME IN ACREAGE SETTING

This unique rotunda home nestled on the edge of Lamington National Park boasts a fresh interior split over two levels. Set on 1.5 acres, it is incredibly private with leafy views and a running stream at the rear of property.

- Open plan layout with air-conditioned living & dining
- Central modern kitchen sitting on timber flooring with gas cooking & stone bench-tops
- Timber ceilings with centre skylight offering an abundance of light
- A 2nd living room or 3rd bedroom on the lower level with wood burning fireplace
- Lower level also features 2 other bedrooms
- Immaculately appointed Bathroom upstairs
- Covered alfresco areas on both levels including an expansive wrap-around



**Disclaimer:** All information contained therein is gathered from relevant third parties sources. We cannot guarantee or give any warranty about the information provided. Interested parties must rely solely on their own enquiries.

3

1

3

#### For Lease

Please Call

#### View

[ljhooker.com.au/34ZMGMK](http://ljhooker.com.au/34ZMGMK)

#### Contact

**Aaron Dobson**

0437 828 228

[adobson@ljhg.com.au](mailto:adobson@ljhg.com.au)

**LJ Hooker Pacific Pines |  
Helensvale  
(07) 5573 2099**



deck

- Separate laundry
- Incredible edible landscaping with huge selection of fruit trees

Additional property features include water tanks, large shed with double bay garaging and workshop zone plus concrete parking pad. There are also numerous amenities close by including serene dining locations and favoured schooling options! Minutes to Binna Burra, Upper Coomera Falls and Beechmont Primary School. To arrange an inspection, please contact Kirsty on 0411 187 021.

PLEASE NOTE: WE ONLY ACCEPT 2APPLY APPLICATIONS (ONLINE)

**\*\*ARRANGE AN INSPECTION TIME ONLINE\*\***

By registering, you will be INSTANTLY informed of any updates, changes or cancellations for your appointment. Please be aware that even though you may be booked in for an inspection, it does sometimes occur that the property may be leased prior to the time and date you have been given. If that occurs you will receive a text informing you of the cancellation.

Registering online will provide you with a 10 minute private viewing. Once registered, you will receive an email from our agency as to the guidelines of entry. Please ensure you read them and adhere to them strictly. Please view the photos and any visual aids you can access thoroughly to ensure that this is a home you are very interested in before registering. Viewings are limited

\* Disclaimer: In preparing this information LJ Hooker has used its best endeavours to ensure that the information contained herein is true and accurate but accept no responsibility and disclaim all liability in respect of any errors, omissions, inaccuracies or misstatements that may occur. Prospective tenants and buyers should make their own enquiries to verify the information contained herein. Photos used in advertising may differ from the current state of the property. We endeavour to use the most up to date photography, however this may not be feasible to protect our current tenants' privacy. Photos may include the use of virtual furniture.



**Disclaimer:** All information contained therein is gathered from relevant third parties sources. We cannot guarantee or give any warranty about the information provided. Interested parties must rely solely on their own enquiries.

**LJ Hooker Pacific Pines |  
Helensvale  
(07) 5573 2099**

# More About this Property

Property ID	34ZMGMK
Property Type	House
Land Area	6094 sqm
Including	Study Air Conditioning Toilets (1) Outdoor Entertaining Built-in-Robes

**Aaron Dobson**  
New Client Manager – Property Investment Management |  
adobson@ljhgc.com.au

**LJ Hooker Pacific Pines | Helensvale (07) 5573 2099**  
8 Discovery Drive, HELENSVALE QLD 4212  
pacificpines-helensvale.ljhooker.com.au | admin@ljhteam.com.au



**Disclaimer:** All information contained therein is gathered from relevant third parties sources. We cannot guarantee or give any warranty about the information provided. Interested parties must rely solely on their own enquiries.

**LJ Hooker Pacific Pines |  
Helensvale  
(07) 5573 2099**

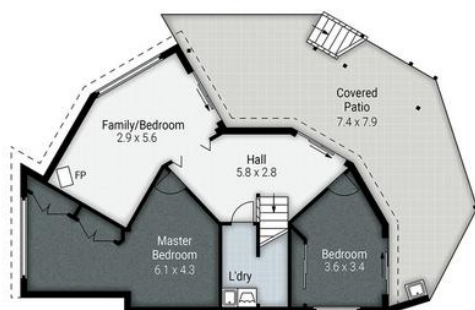

Lower Level

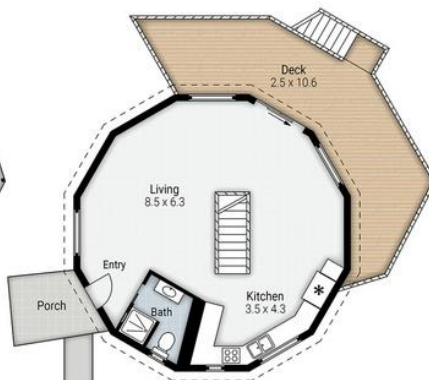

Upper Level

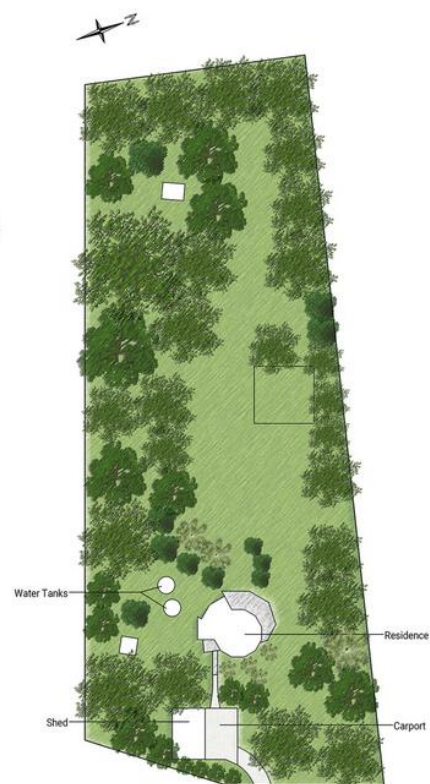

74 - 78 Akoonah Road, Beechmont

Internal: 131m<sup>2</sup> | External: 73m<sup>2</sup> | Total: 204m<sup>2</sup>

Items shown are only indicative of layout. Dimensions are approximate.

**LJ Hooker**

**LJ Hooker**

**LJ Hooker Pacific Pines |  
Helensvale  
(07) 5573 2099**

**Disclaimer:** All information contained therein is gathered from relevant third parties sources. We cannot guarantee or give any warranty about the information provided. Interested parties must rely solely on their own enquiries.