

Ashfield, 12/11 Church Street

Affordable Studio in Desirable Locale

Positioned in a boutique complex within close proximity to Ashfield Park, Ashfield Mall, transport, eateries & cafes, this open plan studio has been recently refreshed with updated fittings & fixtures.

Apartment area 21m2

For further details or to arrange a private viewing please contact LJ Hooker Rockdale on 9597 6144.

0

1

0

For Lease

\$390 wk

View

By Appointment

Contact

Frank Tuma

0402 061 276

frank.tuma@ljhooker.com.au

Matthew Petrevski

0401 610 995

matthew.petrevski@ljhooker.com.au



Disclaimer: All information contained therein is gathered from relevant third parties sources. We cannot guarantee or give any warranty about the information provided. Interested parties must rely solely on their own enquiries.

LJ Hooker Rockdale
(02) 9597 6144

More About this Property

Property ID	4EKHS3
Property Type	Studio
Land Area	21 sqm

Frank Touma 0402 061 276

Director & Sales Executive | frank.touma@ljhooker.com.au

Matthew Petrevski 0401 610 995

Senior Property Executive | matthew.petrevski@ljhooker.com.au

LJ Hooker Rockdale (02) 9597 6144

426 Princes Highway, ROCKDALE NSW 2216

rockdale.ljhooker.com.au | rockdale@ljhooker.com.au

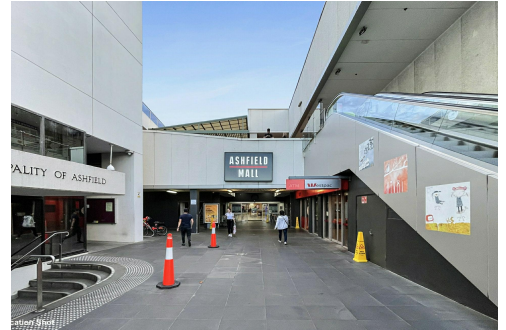

Disclaimer: All information contained therein is gathered from relevant third parties sources. We cannot guarantee or give any warranty about the information provided. Interested parties must rely solely on their own enquiries.

**LJ Hooker Rockdale
(02) 9597 6144**

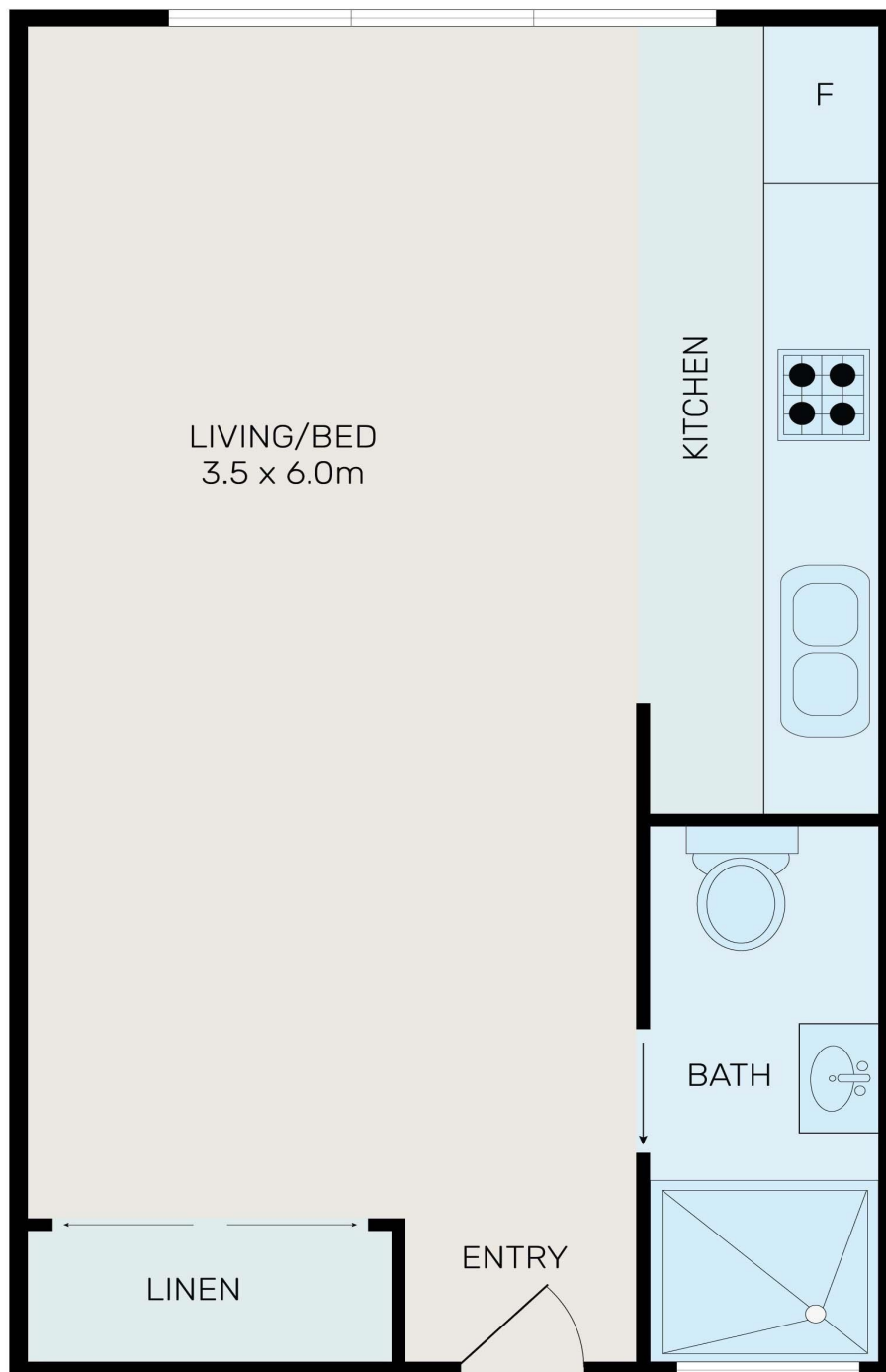

All information contained herein is gathered from all sources we believe to be reliable. However we cannot guarantee its accuracy and interested parties should rely on their own enquiries.



12/11 Church Street Ashfield