

7 Somerville Avenue, Ashfield

2 🏠 1 🚿 2 🚗

## Peaceful Full-Brick Home With Modern Updates

**FOR RENT**  
Please Call

### AGENTS

Matthew Elazzi  
0450 696 110  
matthew@ljha.com.au

Matthew Elazzi  
0450 696 110  
matthew@ljha.com.au

### AGENCY

LJ Hooker Ashfield  
(02) 9797 6044

This beautifully maintained full brick home offers a comfortable and practical layout. It features 2 generous bedrooms, a sunroom perfect for a home office, a renovated kitchen with gas cooking, a bright living room with feature fireplace and air conditioning, a separate dining area, an updated bathroom, internal laundry, and a spacious backyard with level lawn and garden shed. The property also includes 2 car spaces and flexible living areas to suit everyday life.

Situated at the end of a quiet cul-de-sac, the property is just 800m from Ashfield Station and within easy reach of local schools, parks, shops and restaurants. Enjoy a central Ashfield location that offers both lifestyle and practicality for day-to-day living.

#### Property Features:

- 2 generous bedrooms plus sunroom/home office
- Renovated kitchen with gas cooking and stainless steel appliances
- Bright living room with feature fireplace and air conditioning
- Separate dining area
- Modern bathroom with quality finishes
- Internal laundry with rear access
- Spacious backyard with level lawn and garden shed

All information contained therein is gathered from relevant third parties sources. We cannot guarantee or give any warranty about the information provided. Interested parties must rely solely on their own enquiries.



- 2 car spaces
- Quiet cul-de-sac position
- Close to Ashfield Station, schools, shops and parks

DISCLAIMER: This advertisement contains information provided by third parties. While all care is taken to ensure otherwise, LJ Hooker Ashfield does not make any representation as to the accuracy of the information contained in the advertisement, does not accept any responsibility or liability and recommends that any client make their own investigations and enquiries. All images are indicative of the property only.

## MORE DETAILS

Property ID                    1AF9F8B  
Property Type                House

**Matthew Elazzi 0450 696 110**  
Property Investment Co-ordinator | [matthew@ljha.com.au](mailto:matthew@ljha.com.au)  
**Matthew Elazzi 0450 696 110**  
Property Investment Co-ordinator | [matthew@ljha.com.au](mailto:matthew@ljha.com.au)

**LJ Hooker Ashfield (02) 9797 6044**  
216 Liverpool Road, ASHFIELD NSW 2131  
[ashfield.ljhooker.com.au](http://ashfield.ljhooker.com.au) | [ashfield@ljha.com.au](mailto:ashfield@ljha.com.au)



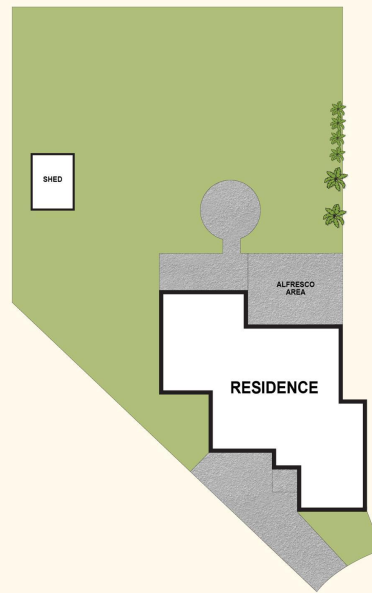

## 7 SOMERVILLE AVENUE, ASHFIELD

### DISCLAIMER

PLANS SHOWN ARE FOR MARKETING PURPOSES ONLY. ALL DIMENSIONS ARE APPROXIMATE AND NOT TO SCALE. THEY ARE SUBJECT TO ERRORS AND INACCURACIES AND NO LIABILITY WILL BE ACCEPTED. INTERESTED PARTIES SHOULD MAKE THEIR OWN ENQUIRIES.



All information contained therein is gathered from relevant third parties sources. We cannot guarantee or give any warranty about the information provided. Interested parties must rely solely on their own enquiries.

