

Newlands Arm, Lot 6/55 Meridian Way

YOUR DREAM LIFESTYLE AWAITS ON 2081M2 ALLOTMENT NEAR THE WATERFRONT

Discover the perfect canvas for your dream home on this expansive 2081m2 lifestyle allotment, ideally situated just a hop, skip and jump from the sparkling waterfront. With sewerage, water and power ready to connect, this property is ready for your vision to come to life.

The allotment is fully fenced, featuring an entry gate and crossover, offering privacy and convenience. There's ample space for your dream home and a large shed, making it the ideal retreat for those seeking room to breathe.

Enjoy the tranquility of the area or take advantage of the nearby boat ramp and walking tracks to explore the wonders of the Gippsland Lakes. Whether you're into boating, fishing, or simply soaking in the peaceful surroundings, this property offers an enviable lifestyle with endless possibilities.

Don't miss this rare opportunity to create your slice of paradise!



LAND 2,081 m²

For Sale
\$290,000

Contact
Lorraine Edlington
0437 532 860
ledlington.paynesville@ljhooker.com.au



Disclaimer: All information contained therein is gathered from relevant third parties sources. We cannot guarantee or give any warranty about the information provided. Interested parties must rely solely on their own enquiries.

LJ Hooker Paynesville | Lakes Entrance | Metung
(03) 5156 6166

More About this Property

Property ID	MBKFCA
Property Type	Residential
Land Area	2081 m ²

Lorraine Edlington 0437 532 860
Officer In Effective Control | Licensed Estate Agent |
ledlington.paynesville@ljhooker.com.au

LJ Hooker Paynesville | Lakes Entrance | Metung (03) 5156 6166
25A Esplanade, PAYNESVILLE VIC 3880
paynesville.ljhooker.com.au | paynesville@ljhooker.com.au

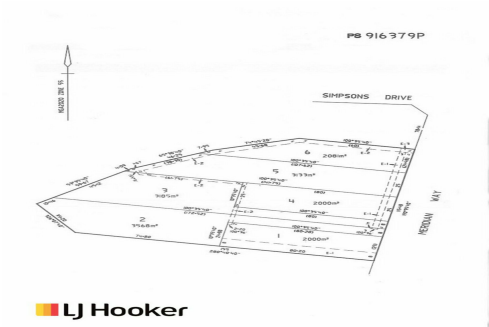

Disclaimer: All information contained therein is gathered from relevant third parties sources.
We cannot guarantee or give any warranty about the information provided. Interested parties must rely solely on their own enquiries.

LJ Hooker Paynesville | Lakes Entrance | Metung (03) 5156 6166