



## Goonellabah, Waterford Park Estate (Stage 10a)

Soothing water views at Waterford Park

Don't miss your chance to secure one of the exclusive water view lots at Waterford Park! These blocks are now registered and ready to build on.

This prime location offers an incredible opportunity to build your dream home —whether it's your first, a second getaway, a retirement haven, or even a dual occupancy (subject to council approval).

Waterford Park is nestled in one of Goonellabah's most sought-after neighbourhoods, directly across from the Goonellabah Sports Club and Hepburn Park. Enjoy the convenience of being close to three shopping centres, the Goonellabah Sports & Aquatic Centre, child care centres, and both primary and high schools. Plus, it's just a short drive to the beautiful coastline.



LAND 885 m<sup>2</sup>

**For Sale**

\$320,000 - \$380,000

**Contact**

**Luke Shay**

0416 275 607

luke.shay@ljhooker.com.au

**Michael Shay**

0427 862 711

mshay.admiral@ljhooker.com.au



**Disclaimer:** All information contained therein is gathered from relevant third parties sources. We cannot guarantee or give any warranty about the information provided. Interested parties must rely solely on their own enquiries.

**LJ Hooker Ballina**  
(02) 6686 2711

Land Sizes ranging from 879.8m2 - 1,156m2

Act quickly —these lots won't last long!

## More About this Property

|               |                    |
|---------------|--------------------|
| Property ID   | 1XY2F5A            |
| Property Type | Residential        |
| Land Area     | 885 m <sup>2</sup> |

**Luke Shay 0416 275 607**  
Salesperson | [luke.shay@ljhooker.com.au](mailto:luke.shay@ljhooker.com.au)  
**Michael Shay 0427 862 711**  
Licensee | [mshay.admiral@ljhooker.com.au](mailto:mshay.admiral@ljhooker.com.au)

**LJ Hooker Ballina (02) 6686 2711**  
87 - 89 River Street, BALLINA NSW 2478  
[ballina.ljhooker.com.au](http://ballina.ljhooker.com.au) | [ballina@ljhooker.com.au](mailto:ballina@ljhooker.com.au)



**Disclaimer:** All information contained therein is gathered from relevant third parties sources.  
We cannot guarantee or give any warranty about the information provided. Interested parties must rely solely on their own enquiries.

**LJ Hooker Ballina**  
**(02) 6686 2711**

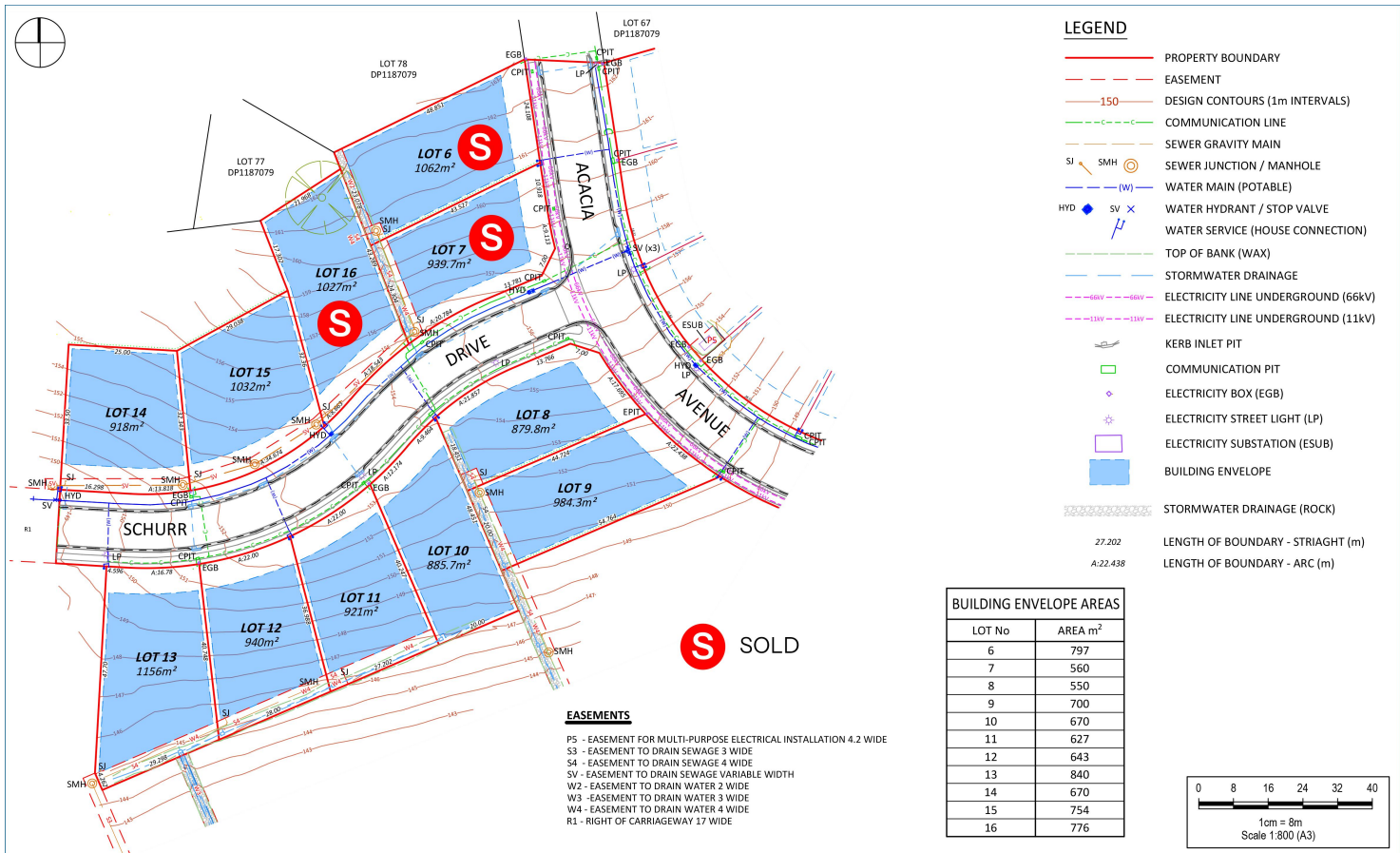

**DISCLAIMER**

- CONTOURS ARE BASED ON FINISHED DESIGN LEVELS AND ARE SUBJECT TO CONSTRUCTION AND COUNCIL CERTIFICATION AND THEREFORE SHOULD NOT BE CONSIDERED AS FINAL OR AS-BUILT.
- LOCATION OF UTILITY SERVICES INCLUDING BUT NOT LIMITED TO POWER, WATER, SEWER AND COMMUNICATIONS ARE SUBJECT TO CONSTRUCTION AND SUPPLY AUTHORITY CERTIFICATION AND THEREFORE SHOULD NOT BE CONSIDERED AS FINAL OR AS-BUILT.
- SURVEY INFORMATION SUCH AS BOUNDARY DIMENSIONS AND AREAS, EASEMENTS ETC ARE SUBJECT TO FINAL SURVEY. PURCHASERS SHOULD REFER TO THE DEPOSITED PLAN AND 888 INSTRUMENT CONTAINED IN THE CONTRACT FOR SALE OF LAND FOR FURTHER DETAILED INFORMATION.
- THIS PRELIMINARY SITE ANALYSIS PLAN HAS BEEN COLLATED FROM VARIOUS SOURCES OF DESIGN INFORMATION AND IS PROVIDED FOR CONVENIENCE TO ASSIST PURCHASERS IN OBTAINING QUOTATIONS/TENDERS FOR DWELLING CONSTRUCTION.
- THIS DOCUMENT DOES NOT FORM PART OF THE CONTRACT OF SALE OF THE LAND.

k:\jobs\2016\16040 - william xavier heights\stage 10\engineering\drawings\160040-10-su-sa - stage 10a (rev c).dwg - stg 10a - all lots sale plan

**LJ Hooker**  
Ballina Land Marketing  
02 6686 2711

**NDC**  
Newton Denny Chapelle  
Surveyors Planners Engineers  
Email: office@ndc.com.au  
LISMORE 31 Carrington St, Lismore 2480 PH: 6622 1011  
CASUARINA Shop B480 Casuarina Way, Casuarina 2487  
ABN: 82 220 061 469

**WATERFORD PARK - STAGE 10A  
SALES PLAN (OVERALL)**  
CLIENT: WILLIAM XAVIER HEIGHT PTY LTD  
LOCATION: ACACIA AVENUE,  
GOONELLABAH NSW  
DATE: 05/02/2025  
SCALE: 1:800 @ A3  
REF: 160010-510-SU-SA-STG 10A  
DRAWN: C.D



**LJ Hooker Ballina**  
(02) 6686 2711

**Disclaimer:** All information contained therein is gathered from relevant third parties sources.  
We cannot guarantee or give any warranty about the information provided. Interested parties must rely solely on their own enquiries.