

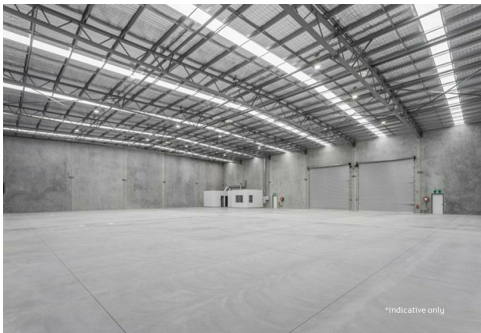

*artist impression

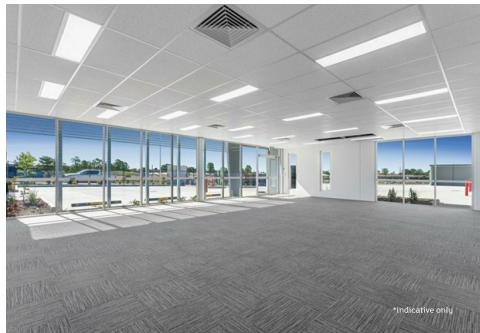

*indicative only



*indicative only



Yatala, 7 Warehouse Circuit

Premium Tilt Slab Warehouse – New Yatala Logistics Hub

- * 1,809sqm New A-Grade Warehouse off Stanmore Road
- * Minimum 8-metre Internal Clearance
- * 3 Container Height Electric Rollers
- * A-Grade Office: Carpets, A/C, Full Amenities
- * Huge Concrete Hardstand with 24 Car bays
- * Security fencing and electric gate access
- * Call John Barter on 0418 632 326 Today!

PRICE: Contact Agent

BUILDING AREA: 1,809 sqm approx.

LAND AREA: 2,915 sqm approx.

For Lease

Contact Agent

Building Area

1,809–1,809sqm

Contact

John Barter

0418 632 326

jbarter@ljhbrisbane.com.au



Brisbane
(07) 3115 7128

Disclaimer: All information contained therein is gathered from relevant third parties sources. We cannot guarantee or give any warranty about the information provided. Interested parties must rely solely on their own enquiries.

Location:

Located approx. 38kms south east of the Brisbane CBD and 45kms north of the Gold Coast, the Yatala enterprise area boasts one of the largest land banks of serviced industrial land in south east QLD. Split by the Pacific Motorway, the area has excellent access on and off the motorway. This provides an integral link to the Logan Motorway only 2kms to the north of the YEA. A large mix of users call the area home including Aldi, Ritchie Bros, CUB and Stratco.

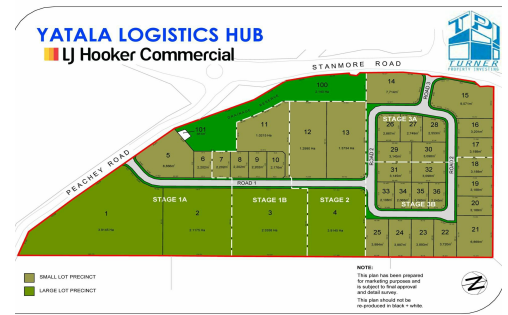

More About this Property

Property ID	1HWNGCF
Property Type	Industrial/Warehouse
Building Area	1809-1809 m ²
Land Area	2915 m ²

John Barter

Sales & Leasing Executive | jbarter@ljhbrisbane.com.au

Brisbane (07) 3115 7128

6/3370 Pacific Highway, SPRINGWOOD QLD 4127

brisbane.ljhcommercial.com.au | brisbane@ljhbrisbane.com.au

