

34a Tapleys Hill Road, Royal Park

Great opportunity for Retail / Warehouse

LJ Hooker Commercial Adelaide are proud to present 34a Tapleys Hill Road, Royal Park to the market for Lease.

This well located property offers a flexible open plan tenancy which can suit a range of uses, with over 176.50 sqm* of versatile area and great exposure in a busy retail area.

Key features:

- 176.50sqm* open plan tenancy
- Located opposite Hendon Central
- Premium signage opportunities
- Exposure to 20,000* vehicles daily
- Ample on-site customer parking
- Toilets and shower

LJ Hooker Commercial Adelaide are proud to present 34C Tapleys Hill Road, Royal Park

Key features:

- 337.60 sqm* open plan tenancy

All information contained therein is gathered from relevant third parties sources. We cannot guarantee or give any warranty about the information provided. Interested parties must rely solely on their own enquiries.

FOR LEASE
Contact Agent

BUILDING AREA
177sqm

AGENTS

Rino Pancione
0417 822 987
rino.pancione@ljhcommercialadelaide.com.au

Anton Faranda
0401 818 436
anton.faranda@ljhcommercialadelaide.com.au

AGENCY

Adelaide
(08) 8232 8844

 **LJ Hooker Commercial**

- Located opposite Hendon Central
- Premium signage opportunities
- Exposure to 21,300* vehicles daily
- Ample off-street parking
- Suited to a range of uses (STCC)
- Bathroom amenities

For further information or to organise an inspection please contact,

Rino Pancione 0417 822 987 or Anton Faranda 0401 818 436

Approx. *

RLA 231015

MORE DETAILS

Property ID	8JVH94
Property Type	Industrial/Warehouse Showrooms/Bulky Goods Retail
Building Area	176.5 m2

Rino Pancione 0417 822 987

Principal | rino.pancione@ljhcommercialadelaide.com.au

Anton Faranda 0401 818 436

Commercial Property Management |
anton.faranda@ljhcommercialadelaide.com.au

Adelaide (08) 8232 8844

81 Flinders Street, ADELAIDE SA 5000
adelaide.ljhcommercial.com.au |
commercialadelaide@ljhcommercialadelaide.com.au



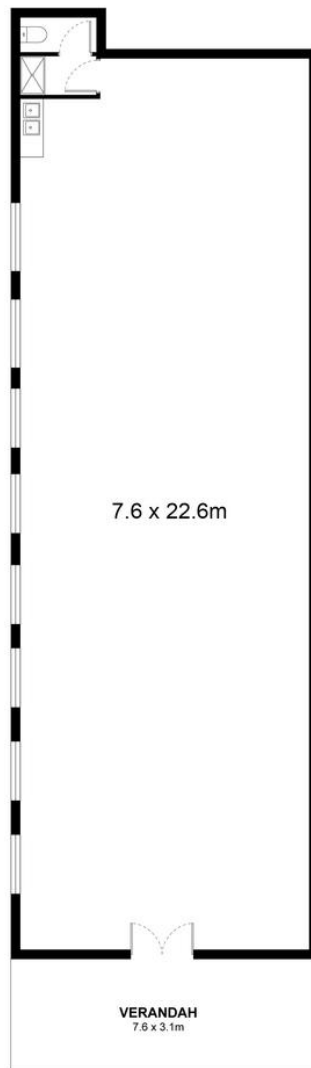

NET LETTABLE AREA - 174m²

Verandah - 23m²

Measurements are approximate



32 Tapleys Hill Road, Royal Park, SA 5014

Disclaimer: The information & figures obtained within this document has been compiled from information provided by vendor & sources that we believe are reliable. No warranty is given to their accuracy & all figures are subject to change without notice.