



Wh 3/106 Gipps Street, North Wollongong

## Garage / Storage

Opportunity to lease a Warehouse in secure complex close to Wollongong CBD

- Wide roller door entry, with wide turning bay for entry
- 6.6m wide x 11.2m deep
- Single phase power.
- E3 Productivity Support

### FOR LEASE

Contact Agent

### BUILDING AREA

77sqm

### AGENTS

Chris Tudzarov

0451 714 441

[chris.tudzarov@ljhwollongong.com.au](mailto:chris.tudzarov@ljhwollongong.com.au)

Con Papadopoulos

0408 604 040

[con.papadopoulos@ljhwollongong.com.au](mailto:con.papadopoulos@ljhwollongong.com.au)

### AGENCY

LJ Hooker Wollongong | Corrimal |

Shellharbour

(02) 4229 8600

## MORE DETAILS

Property ID	VX6HQZ
Property Type	Industrial/Warehouse
Building Area	77 m2

**Chris Tudzarov 0451 714 441**

Commercial Sales & Leasing | [chris.tudzarov@ljhwollongong.com.au](mailto:chris.tudzarov@ljhwollongong.com.au)

**Con Papadopoulos 0408 604 040**

Commercial Property Manager |  
[con.papadopoulos@ljhwollongong.com.au](mailto:con.papadopoulos@ljhwollongong.com.au)

**LJ Hooker Wollongong | Corrimal | Shellharbour (02) 4229 8600**

69 Kembla Street, WOLLONGONG NSW 2500  
[wollongong.ljhooker.com.au](http://wollongong.ljhooker.com.au) | [wollongong@ljhooker.com.au](mailto:wollongong@ljhooker.com.au)

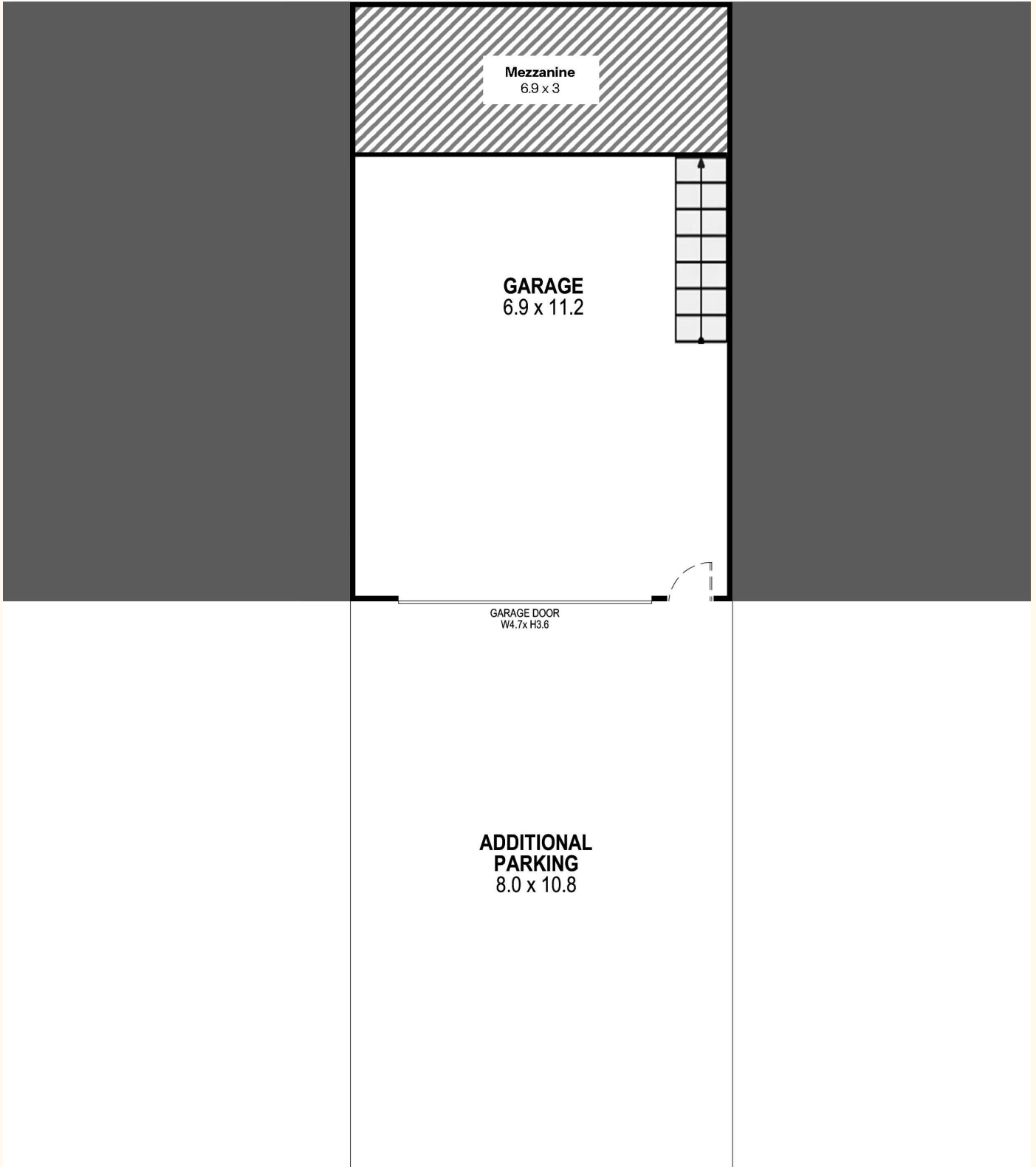

PLANS SHOWN ONLY INDICATIVE OF LAYOUT. DIMENSIONS ARE APPROXIMATE.

Internal	77sqm
Mezzanine	21sqm
Hardstand/Parking	86sqm

**Warehouse 3, 106 Gipps Street, Wollongong**

All information contained therein is gathered from relevant third parties sources.  
We cannot guarantee or give any warranty about the information provided.  
Interested parties must rely solely on their own enquiries.

