



Edinburgh North, 19 Priority Court

Secure Office/Warehouse Facility

LJ Hooker Commercial Adelaide are pleased to present Tenancy B, 19 Priority Court, Edinburgh North to the property for lease.

The property is conveniently located to Womma Road, Main North Road, and the Northern Expressway, providing excellent connectivity to Adelaide's northern corridor.

Key features include:

- 360 sqm* warehouse
- 21 sqm* modern office/amenities
- 4.6-5.8m* internal clearance
- Two roller door entries
- Secure site
- 3-phase power

For Lease
Contact Agent

Building Area
384sqm

Contact
Mark Tettis
0433 139 892
mark.tettis@ljhcommercialadelaide.com.au

John Zavos
0414 229 211
john.zavos@ljhcommercialadelaide.com.au



Disclaimer: All information contained therein is gathered from relevant third parties sources. We cannot guarantee or give any warranty about the information provided. Interested parties must rely solely on their own enquiries.

Adelaide
(08) 8232 8844

- Rear lay down area

For further information or to organise an inspection please contact Mark Tettis 0433 139 892 or John Zavos 0414 229 211.

* approx.

** All information provided has been obtained from sources we believe to be accurate, however, we cannot guarantee the information is accurate and we accept no liability for any errors or omissions (including but not limited to a property's land size, floor plans and size, building age and condition). Interested parties should make their own enquiries and obtain their own legal advice.

RLA 231 015



More About this Property

Property ID	8EAH94
Property Type	Industrial/Warehouse
Building Area	384 m2

Mark Tettis 0433 139 892

Sales & Leasing - Commercial | mark.tettis@ljhcommercialadelaide.com.au

John Zavos 0414 229 211

Sales & Leasing - Commercial | john.zavos@ljhcommercialadelaide.com.au

Adelaide (08) 8232 8844

81 Flinders Street, ADELAIDE SA 5000

adelaide.ljhcommercial.com.au |

commercialadelaide@ljhcommercialadelaide.com.au

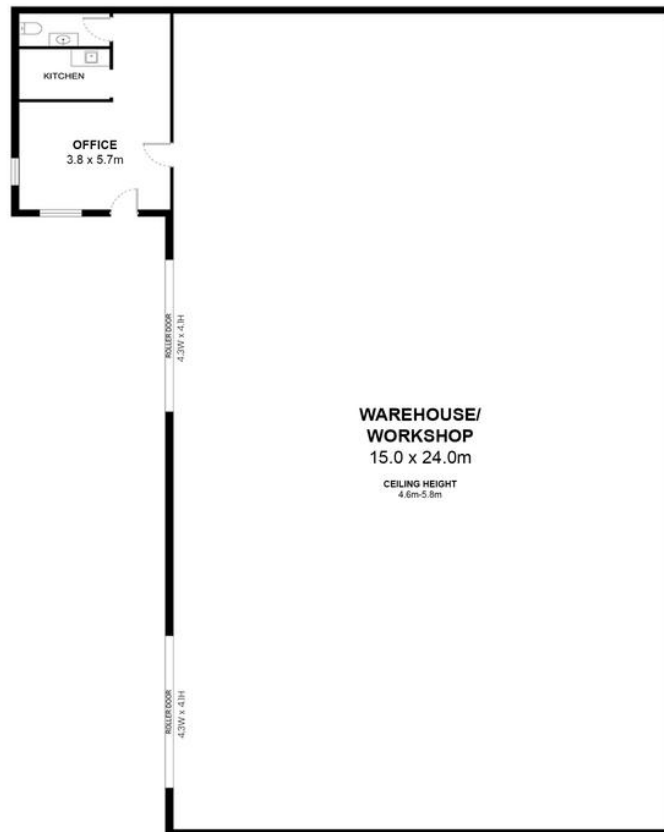

- ☐ Warehouse/Workshop - 360m²
- ☐ Office/Amenities - 21.6m²
- ☐ Total Lettable Area - 381.6m²

Measurements are approximate



19 Priority Court, Edinburgh North SA 5113

Disclaimer: The information & figures obtained within this document has been compiled from information provided by vendor & sources that we believe are reliable. No warranty is given to their accuracy & all figures are subject to change without notice.