



Burleigh Heads, 6 Hutchinson Street

Expansive Hardstand, 380m² Warehouse

Property Overview

Located in Burleigh Heads' industrial precinct, 6 Hutchinson Street offers a prime opportunity for businesses seeking expansive industrial space.

Key Features

Total Land Area: 2,251 m²

Building Area: 380 m² of warehouse

Parking: Ample on-site parking available

Lease Details

Rental Rate: \$130,000p.a +GST +outgoings

Lease Term: Current term ends 26/05/2026

Options: Two x 3 year options

Annual increases: 4% on the anniversary date and market reviews at options

For Lease

\$10,833.33pcm +GST +Outgoings

Building Area

380sqm

Contact

Jack Young

0404 035 871

jack@ljhookersgc.com.au



Disclaimer: All information contained therein is gathered from relevant third parties sources.

We cannot guarantee or give any warranty about the information provided. Interested parties must rely solely on their own enquiries.

Southern Gold Coast
(07) 5576 5500

The annual rent increases to \$135,200p.a +GST +Outgoings as of 27/05/2025

Property Highlights

Strategic Location: Situated within Burleigh Heads', the property offers easy access to major transportation routes, facilitating efficient logistics and distribution.

Versatile Space: The expansive hardstand area is suitable for a variety of industrial uses, including manufacturing, warehousing, and distribution.

Functional Design: The 380 m² clear span building provides practical space for operations, or storage, catering to diverse business requirements.



For more information or to arrange an inspection, please contact:

Jack Young 0404 035 871

LJ Hooker Commercial Southern Gold Coast

Disclaimer:

All information (including but not limited to the property area, floor size, price, address and general property description) is provided as a convenience to you, and has been provided to LJ Hooker by third parties. LJ Hooker is unable to definitively confirm whether the information listed is correct or 100% accurate. LJ Hooker does not accept any liability (direct or indirect) for any injury, loss, claim, damage or any incidental or consequential damages, including but not limited to lost profits or savings, arising out of or in any way connected with the use of any information, or any error, omission or defect in the information, contained on the Website. Information contained on the Website should not be relied upon and you should make your own enquiries and seek legal advice in respect of any property on the Website. Prices displayed on the Website are current at the time of issue, but may change.

More About this Property

| | |
|----------------------|----------------------|
| Property ID | 1Q2HXB |
| Property Type | Industrial/Warehouse |
| Building Area | 380 m2 |
| Land Area | 2251 m2 |

Jack Young 0404 035 871

Commercial Sales & Leasing Specialist | jack@ljhookersgc.com.au

Southern Gold Coast (07) 5576 5500

1/18 Park Ave, BURLEIGH HEADS QLD 4220

southerngoldcoast.ljhcommercial.com.au | commercial@ljhookersgc.com.au

6 Hutchinson Street
Burleigh Heads 4220

LJ Hooker
Commercial
Southern Gold Coast

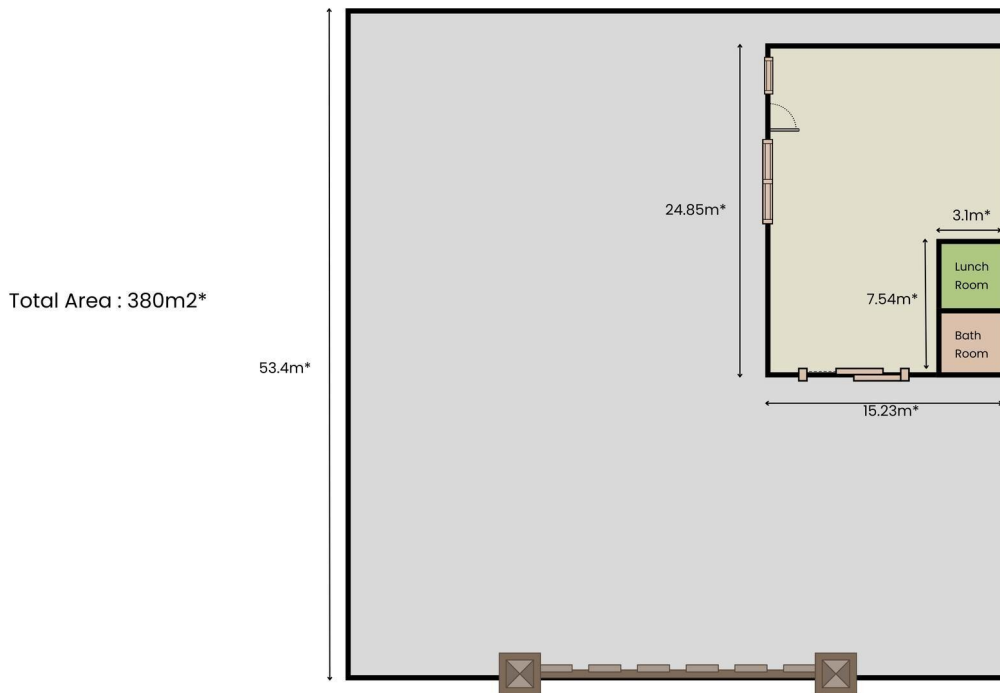

Jack Young
0404 035 871
jack@ljhookersgc.com.au

DISCLAIMER:
Plans shown are only indicative of layout.
Dimensions are approximate.
*Approximate

LJ Hooker

LJ Hooker Commercial

Southern Gold Coast
(07) 5576 5500

Disclaimer: All information contained therein is gathered from relevant third parties sources.
We cannot guarantee or give any warranty about the information provided. Interested parties must rely solely on their own enquiries.