



## Toronto, 3/8 Woodbine Place

### SECURE & MODERN WORKSHOP OR STORAGE FACILITY

This is a fantastic opportunity to purchase your own space for storage, workshop or both and forget renting forever.

Are you in search of the perfect space to meet your storage or workshop requirements? Look no further! Presenting an exceptional storage shed and or workshop space situated in a prime location just minutes from Toronto and the MI Motorway.

This property offers an array of features that cater to the needs of both individuals and businesses, making it the ideal choice for your next venture. Don't let this chance slip through your fingers to secure your dream space.

This marvelous property boasts a range of attractive features:



**Disclaimer:** All information contained therein is gathered from relevant third parties sources. We cannot guarantee or give any warranty about the information provided. Interested parties must rely solely on their own enquiries.

#### For Sale

\$400,000

#### Building Area

114sqm

#### Contact

**Kane Bradley**

0423 525 335

kbradley.maitland@ljhooker.com.au

**LJ Hooker Maitland**  
**(02) 4933 5511**

**Generous Space:** With 114 square meters of room, you'll have ample space to accommodate your needs.

**Convenient Access:** A motorized roller door ensures easy entry and exit, streamlining your daily operations.

**Maximized Interior Height:** Enjoy a substantial 4.5 meters of internal clearance, providing flexibility for various uses.

**Built to Last:** The sturdy concrete panel construction guarantees long-lasting durability.

**Security First:** The premises are fully fenced and gated, prioritizing the safety and security of your belongings.

**24/7 Accessibility:** Gain around-the-clock access to your unit, so you can work on your projects at your own pace.

**Utilities:** Essential utilities for power and lighting are readily available for your convenience.  
**3 Phase Power:** Perfect for accommodating heavy machinery and power-intensive tasks. A dedicated toilet and kitchenette ensure you have everything you need within your workspace.

**Awesome Access:** Benefit from dual entry and exit points, offering great convenience and flexibility. Situated in a sought-after area, you'll enjoy easy access to essential amenities and services. Whether you're a craftsman, hobbyist, or a business owner in need of additional storage space, this property offers the versatility and accessibility you desire.

Don't let this incredible opportunity pass you by. Contact us today to arrange a viewing and fully experience the potential of this fantastic storage shed and workshop.

Proudly marketed by LJ Hooker Maitland, please call exclusive agent Kane Bradley 0423 525 335 7 days for all inspections & further information.

All information contained herein is gathered from sources we deem to be reliable. However, we cannot guarantee its accuracy and interested persons should rely on their own enquiries.



**LJ Hooker Maitland**  
**(02) 4933 5511**

**Disclaimer:** All information contained therein is gathered from relevant third parties sources. We cannot guarantee or give any warranty about the information provided. Interested parties must rely solely on their own enquiries.

# More About this Property

Property ID	1CTWF6H
Property Type	Other
Building Area	114 m²

**Kane Bradley 0423 525 335**  
Director | [kbradley.maitland@ljhooker.com.au](mailto:kbradley.maitland@ljhooker.com.au)

**LJ Hooker Maitland (02) 4933 5511**  
24 Ken Tubman Drive, MAITLAND NSW 2320  
[maitland.ljhooker.com.au](mailto:maitland.ljhooker.com.au) | [maitland@ljhooker.com.au](mailto:maitland@ljhooker.com.au)



**LJ Hooker Maitland**  
**(02) 4933 5511**

**Disclaimer:** All information contained therein is gathered from relevant third parties sources. We cannot guarantee or give any warranty about the information provided. Interested parties must rely solely on their own enquiries.

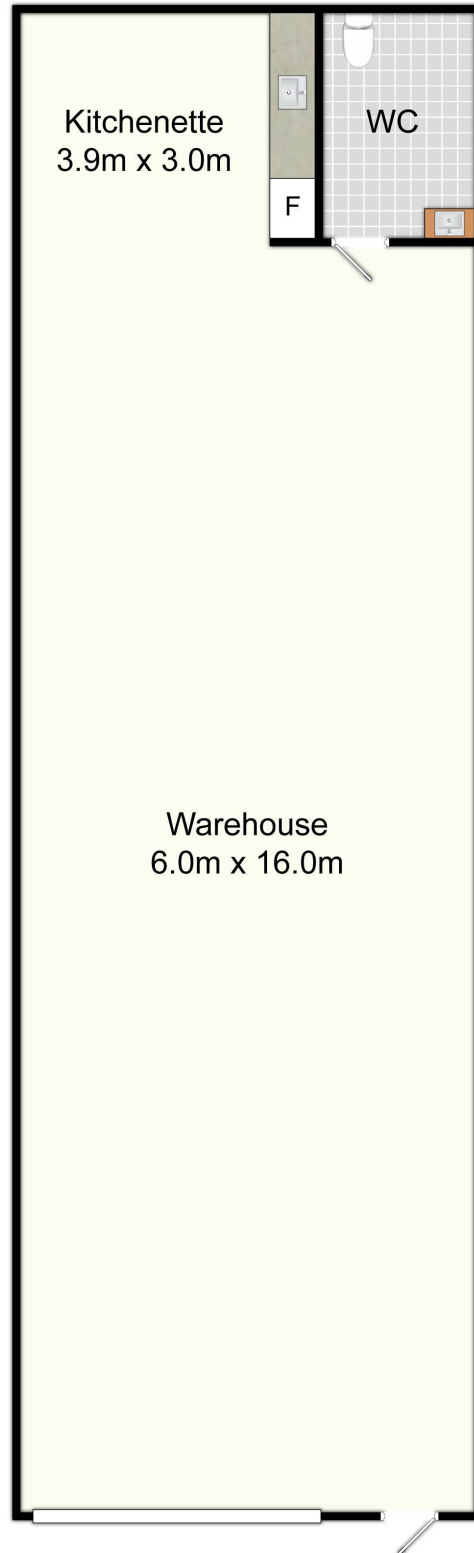

Unit 3, 8 Woodbine Pl, Toronto

All information contained herein is gathered from sources we deem reliable. However, we cannot guarantee its accuracy and act as a messenger only in passing on the details. Interested parties should rely on their own inquiries and the contract for sale. The floor plans are artist's impressions only. The site plan is not to scale.



**Disclaimer:** All information contained therein is gathered from relevant third parties sources. We cannot guarantee or give any warranty about the information provided. Interested parties must rely solely on their own enquiries.



Maitland

LJ Hooker Maitland

(02) 4933 5511

