

Surfers Paradise, 3078 Surfers Paradise Boulevard

Last Office Left! - 26m² - Central Location

Located in a quiet, boutique building, these professional first-floor office suites offer a range of flexible options for small businesses. With individual air-conditioning, kitchenettes, and prime positioning, these spaces are ideal for offices, clinics, beauty services, or storage needs. Enjoy west-facing views, ample natural light, and a central location, all with easy access to one car park per tenancy.

Available Suites:

Suite 4 (26m²) —West-facing, open plan, carpeted

Each tenancy comes with access to shared facilities including a welcoming seating area and bathrooms.

For Lease

From \$220 pw + Outgoings + GST

Building Area

26sqm

Contact

Dominic Eaves

0433 751 733

dominic@ljhookersgc.com.au



Disclaimer: All information contained therein is gathered from relevant third parties sources. We cannot guarantee or give any warranty about the information provided. Interested parties must rely solely on their own enquiries.

Southern Gold Coast
(07) 5576 5500

For further details or to arrange an inspection, please contact Dominic Eaves on 0406 541 278.

Disclaimer:

All information (including but not limited to the property area, floor size, price, address and general property description) is provided as a convenience to you, and has been provided to LJ Hooker by third parties. LJ Hooker is unable to definitively confirm whether the information listed is correct or 100% accurate. LJ Hooker does not accept any liability (direct or indirect) for any injury, loss, claim, damage or any incidental or consequential damages, including but not limited to lost profits or savings, arising out of or in any way connected with the use of any information, or any error, omission or defect in the information, contained on the Website. Information contained on the Website should not be relied upon and you should make your own enquiries and seek legal advice in respect of any property on the Website. Prices displayed on the Website are current at the time of issue, but may change.

More About this Property

Property ID	1M3HXB
Property Type	Offices
Building Area	26 m2

Dominic Eaves 0433 751 733
Commercial Sales & Leasing Specialist | dominic@ljhookersgc.com.au

Southern Gold Coast (07) 5576 5500
1/18 Park Ave, BURLEIGH HEADS QLD 4220
southerngoldcoast.ljhcommercial.com.au | commercial@ljhookersgc.com.au

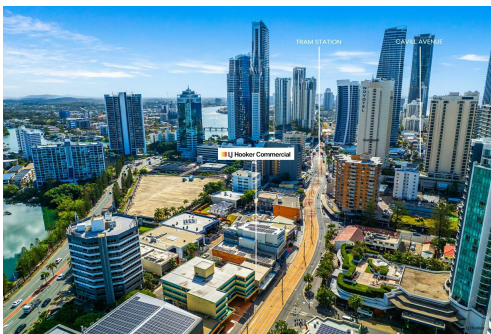
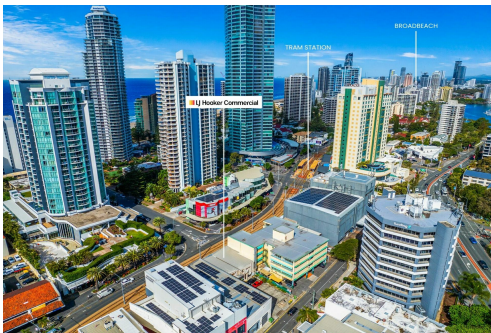

Disclaimer: All information contained therein is gathered from relevant third parties sources. We cannot guarantee or give any warranty about the information provided. Interested parties must rely solely on their own enquiries.

Southern Gold Coast
(07) 5576 5500

5/3078 Surfers Paradise Blvd

Surfers Paradise

Car Spaces : 1
Size: 26m²

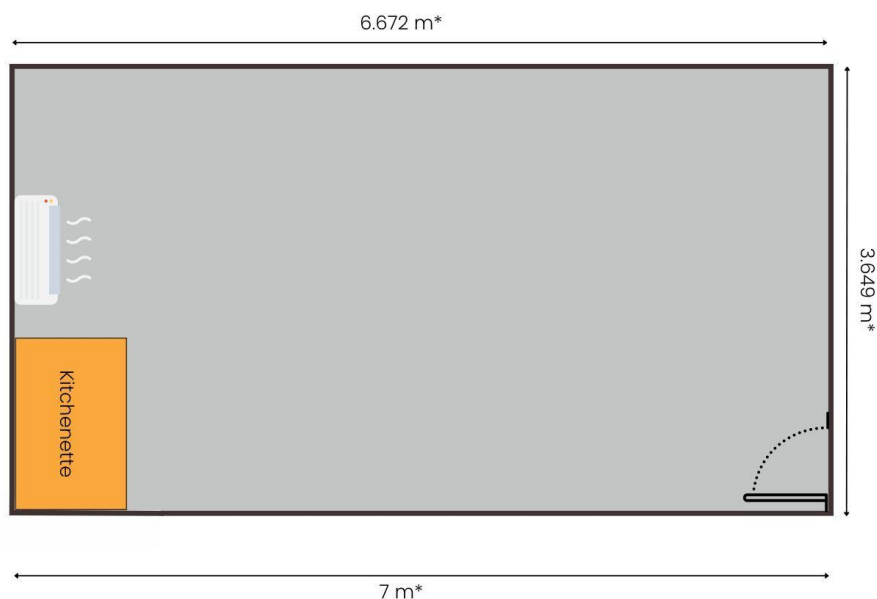

Teresa Skordou
0424 054 226
teresa@ljhookersgc.com.au

DISCLAIMER:
Plans shown are only indicative of layout.
Dimensions are approximate.
• Approximate

LJ Hooker