



95 Beulah Road, Norwood

## Brilliance on Beulah Road Norwood

Auction Location: 95 Beulah Road, Norwood SA 5067

95 Beulah Road Norwood, 5067

FOR SALE By Auction Friday 27th March at 11.30am on site.

Inspections Friday 6th March, Friday 13th March and Friday 20th March at 11.30am.

- 643sqm\* site
- Fully renovated office of 125sqm\* plus 7sqm\* cellar
- Significant further development potential (STCC)
- Zoned Business Neighbourhood

Opportunities in this tightly held commercial pocket are rare. Whether you're an owner-occupier looking to elevate your business presence or an investor seeking strong rental demand in a blue-chip suburb, 95 Beulah Road, Norwood delivers on location, flexibility, and future growth.

Flexible floorplan suitable for office, consulting, or retail use  
Professional presentation with restored traditional finishes and modern conveniences

- site parking and convenient customer access

Excellent signage opportunities

Strong surrounding mix of retail, hospitality & professional services.

**FOR SALE**  
Contact Agent

**BUILDING AREA**  
132sqm

### AGENTS

Mario Bonomi  
0412 080 993

[mario.bonomi@ljhcommercialadelaide.com.au](mailto:mario.bonomi@ljhcommercialadelaide.com.au)

Joanne Chapley  
0403 056 889

[jo.chapley@ljhcommercialadelaide.com.au](mailto:jo.chapley@ljhcommercialadelaide.com.au)

### AGENCY

Adelaide  
(08) 8232 8844

All information contained therein is gathered from relevant third parties sources.  
We cannot guarantee or give any warranty about the information provided.  
Interested parties must rely solely on their own enquiries.

 **LJ Hooker Commercial**

Mario Bonomi 0412 080 993  
Jo Chapley 0403 056 889  
LJHooker Commercial Adelaide

RLA: 231015

## MORE DETAILS

Property ID	8JXH94
Property Type	Offices Medical/Consulting Other
Building Area	132 m2

### Mario Bonomi 0412 080 993

Principal | [mario.bonomi@ljhcommercialadelaide.com.au](mailto:mario.bonomi@ljhcommercialadelaide.com.au)

### Joanne Chapley 0403 056 889

Commercial Sales & Leasing |  
[jo.chapley@ljhcommercialadelaide.com.au](mailto:jo.chapley@ljhcommercialadelaide.com.au)

### Adelaide (08) 8232 8844

81 Flinders Street, ADELAIDE SA 5000  
[adelaide.ljhcommercial.com.au](http://adelaide.ljhcommercial.com.au) |  
[commercialadelaide@ljhcommercialadelaide.com.au](mailto:commercialadelaide@ljhcommercialadelaide.com.au)



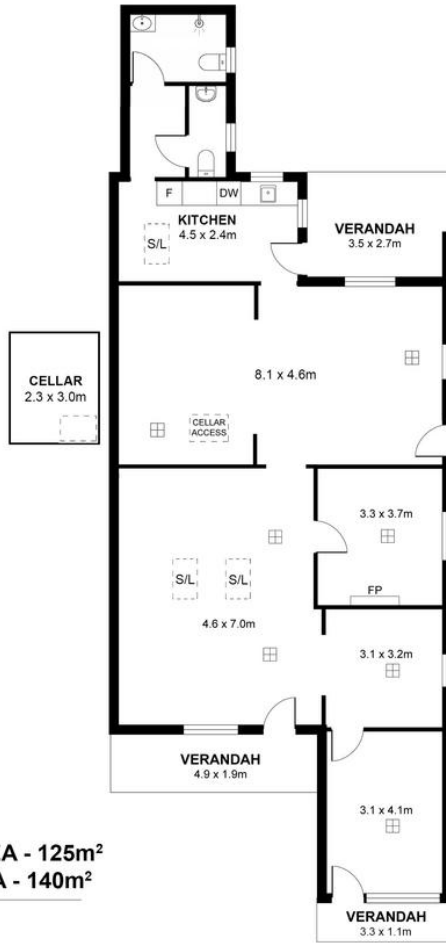
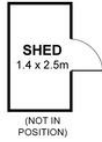

**NET LETTABLE AREA - 125m<sup>2</sup>**  
**GROSS BUILD AREA - 140m<sup>2</sup>**  
 Cellar - 7m<sup>2</sup>  
 Verandahs - 13m<sup>2</sup>  
 Shed - 3m<sup>2</sup>

Measurements are approximate



**95 Beulah Road, Norwood, SA 5067**

**Disclaimer:** The information & figures obtained within this document has been compiled from information provided by vendor & sources that we believe are reliable. No warranty is given to their accuracy & all figures are subject to change without notice.