



146 King William Road, Hyde Park

## Prominent Hospitality/Retail Space

LJ Hooker Commercial Adelaide are pleased to present 146 King William Road, Hyde Park to the market for Lease.

Located only 2.5km\* from the CBD, the property offers an incredible retail or hospitality opportunity in one of Adelaide's best high streets.

Key features:

- 123 sqm\* tenancy
- Prime frontage to King William Road with excellent signage opportunity
- High traffic area
- Rear onsite parking
- Suited to a range of uses
- 9.75kW solar system

For further information or to organise an inspection please contact Rino Pancione 0417 822 987 or Brooke Stead on 0404 226 919.

RLA 231 015

- approx

**FOR LEASE**  
Contact Agent

**BUILDING AREA**  
123sqm

**AGENTS**

Rino Pancione  
0417 822 987  
rino.pancione@ljhcommercialadelaide.com.au

Brooke Stead  
0404 226 919  
brooke.stead@ljhcommercialadelaide.com.au

**AGENCY**  
Adelaide  
(08) 8232 8844

- \* All information provided has been obtained from sources we believe to be accurate, however, we cannot guarantee the information is accurate and we accept no liability for any errors or omissions (including but not limited to a property's land size, floor plans and size, building age and condition). Interested parties should make their own enquiries and obtain their own legal advice.

## MORE DETAILS

Property ID 8H9H94  
Property Type Retail  
Offices  
Medical/Consulting  
Building Area 123 m2

### Rino Pancione 0417 822 987

Principal | [rino.pancione@ljhcommercialadelaide.com.au](mailto:rino.pancione@ljhcommercialadelaide.com.au)

### Brooke Stead 0404 226 919

Commercial Sales & Leasing |

[brooke.stead@ljhcommercialadelaide.com.au](mailto:brooke.stead@ljhcommercialadelaide.com.au)

### Adelaide (08) 8232 8844

81 Flinders Street, ADELAIDE SA 5000

[adelaide.ljhcommercial.com.au](http://adelaide.ljhcommercial.com.au) |

[commercialadelaide@ljhcommercialadelaide.com.au](mailto:commercialadelaide@ljhcommercialadelaide.com.au)



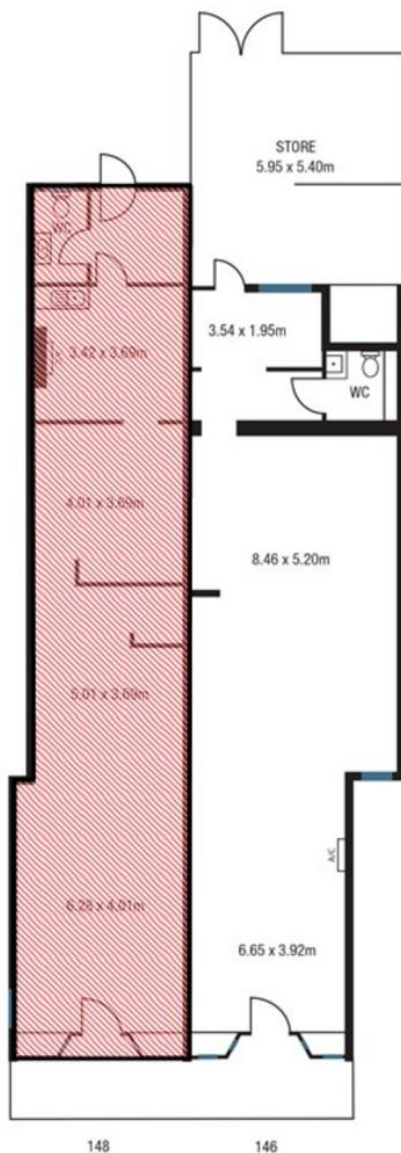

0 1 2 3 4 5  
 Scale in metres. Inductive Only. Dimensions are approximate.

146 : 123m<sup>2</sup>  
 148 : 85m<sup>2</sup> 

146 - 148 King William Road, Hyde Park

All information contained therein is gathered from relevant third parties sources.  
 We cannot guarantee or give any warranty about the information provided.  
 Interested parties must rely solely on their own enquiries.