



## Hackham, Shopping Centre/154 Main South Road

### Last Remaining Tenancy at Hackham Shopping Centre!

The Hackham Shopping Centre located on the corner of Main South Road and Penneys Hill Road is a high profile shopping complex.

The Key Highlights of the property are as follows:

- \* Tenancy Area is approx. 75m<sup>2</sup>\*
- \* Open-Plan Tenancy with Natural Light
- \* Ample on-site parking of approx. 100\* car parks
- \* Large Exposure to Passing Traffic
- \* Two way access with easy in and out from both streets
- \* Excellent Signage Opportunity

 **LJ Hooker Commercial**

**Disclaimer:** All information contained therein is gathered from relevant third parties sources. We cannot guarantee or give any warranty about the information provided. Interested parties must rely solely on their own enquiries.

#### For Lease

Contact Agent

#### Building Area

75sqm

#### Contact

**Fendi Klementou**

0426 258 030

fendi.klementou@ljhcommercialadelaide.com.au

**Adelaide**

**(08) 8232 8844**

- \* High Exposure Centre
- \* Suitable for a number of uses (STCC)
- \* Motivated Landlord

This is a very functional facility in a highly profiled and accessible location.

We have recently secured the following operators who have brand new fit outs:

- Pharmacy (scheduled to open Q1 2023)
- GP Medical Centre (Now open)
- Trittico Italian Restaurant (Now open)

In addition to these new additions, other surrounding tenancies include:

- Drakes Supermarket
- Hairdresser
- Chicken Zone
- Subway

Please contact Fendi Klementou on 0426 258 030.

RLA 231015

## More About this Property

<b>Property ID</b>	5J9H94
<b>Property Type</b>	Retail
<b>Building Area</b>	75 m <sup>2</sup>

### Fendi Klementou 0426 258 030

Sales & Leasing - Commercial |

fendi.klementou@ljhcommercialadelaide.com.au

### Adelaide (08) 8232 8844

2a Portrush Road, PAYNEHAM SA 5070

adelaide.ljhcommercial.com.au |

commercialadelaide@ljhcommercialadelaide.com.au



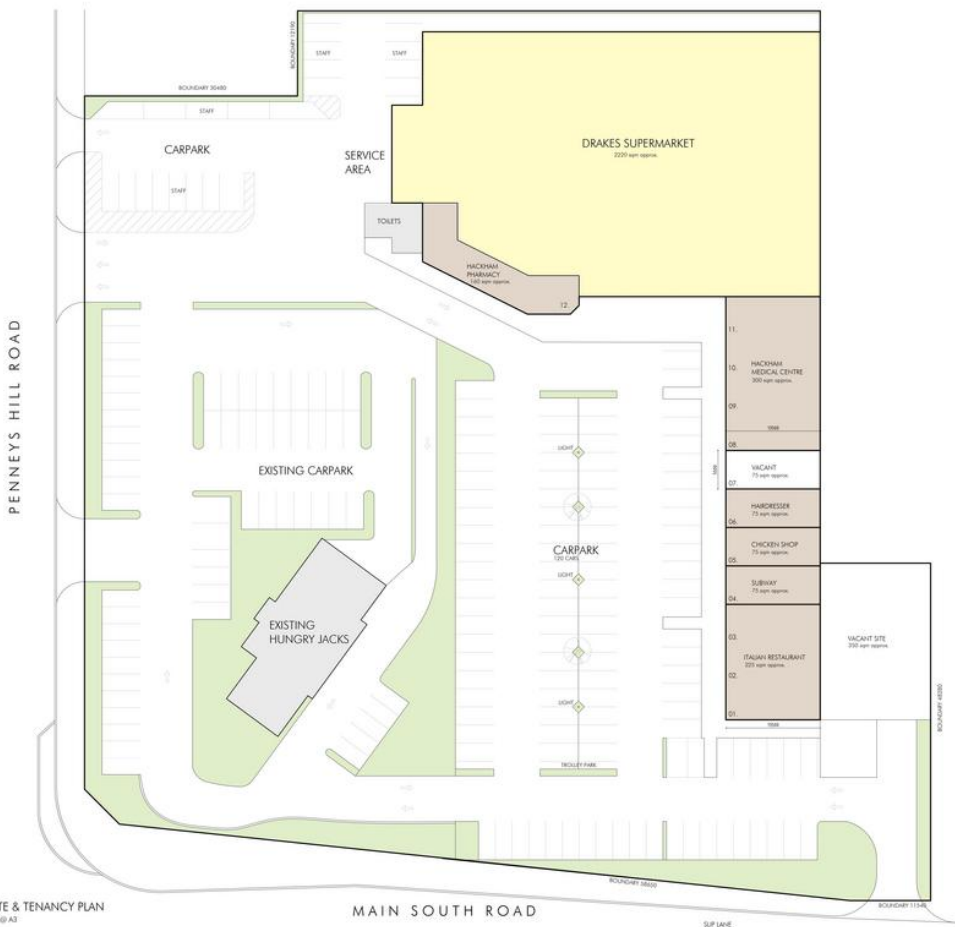

EXISTING SITE & TENANCY PLAN  
1:250 @ A1, 1:500 @ A2

	<p><b>HICKMAN PLAZA TENANCY / SITE PLAN</b></p> <p>GENERAL LAYOUT OF PROPOSED TENANCY AND EXISTING CARPARKS SOUTH WING, HICKMAN PLAZA FOR JOINT HICKMAN PTY LTD.</p>	<p>Issue checked by date issue date revision</p> <p>11/10/2022</p>	<p>Drawings are not for construction purposes unless stamped FOR CONSTRUCTION. Further to work of professional bodies and any relevant competency requirements @ 2022</p>		<p>P: +61 8 8225 6556 W: piteoarchitects.com.au A: 171 Gileys Street, Adelaide, SA 5000</p>	<p><b>PITEOARCHITECTS</b></p>
--	--	--	---	--	---	-------------------------------